

Submittal Data

PROJECT: _____	UNIT TAG: _____	QUANTITY: _____
REPRESENTATIVE: _____	TYPE OF SERVICE: _____	DATE: _____
ENGINEER: _____	SUBMITTED BY: _____	DATE: _____
CONTRACTOR: _____	APPROVED BY: _____	DATE: _____
	ORDER NO.: _____	DATE: _____



SEG.A20.30.EX.2.60M

Submersible Grundfos SEG sewage grinder pumps (0.9-4 kW) are designed for pumping wastewater, sludge-containing water, and sewage. Fitted with a patented grinder system designed to grind the media.

Note! Product picture may differ from actual product

Conditions of Service	Pump Data	Motor Data
Temperature: 68 °F	Maximum operating pressure: 87.02 psi	Rated voltage: 200-230 V
Specific Gravity: 1.000	Liquid temperature range: 32 .. 104 °F	Mains frequency: 60 Hz
	Maximum ambient temperature: 104 °F	Number of poles: 2
	Approvals: CSA, FM	Enclosure class: IP68
	Flange standard: ANSI	Insulation class: F
	Product number: 98280862	Motor protection: THERMAL SWITCH
		Thermal protection: EXT.

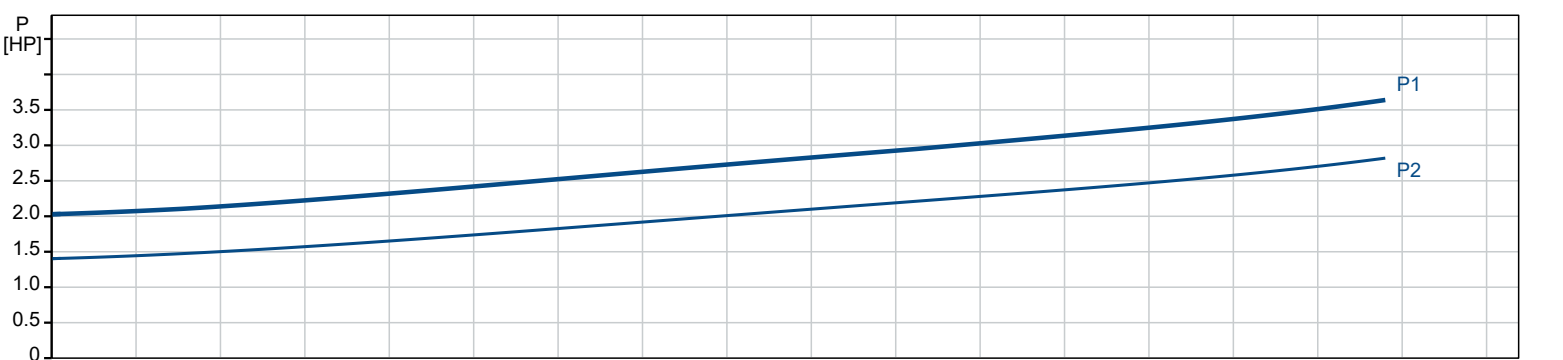
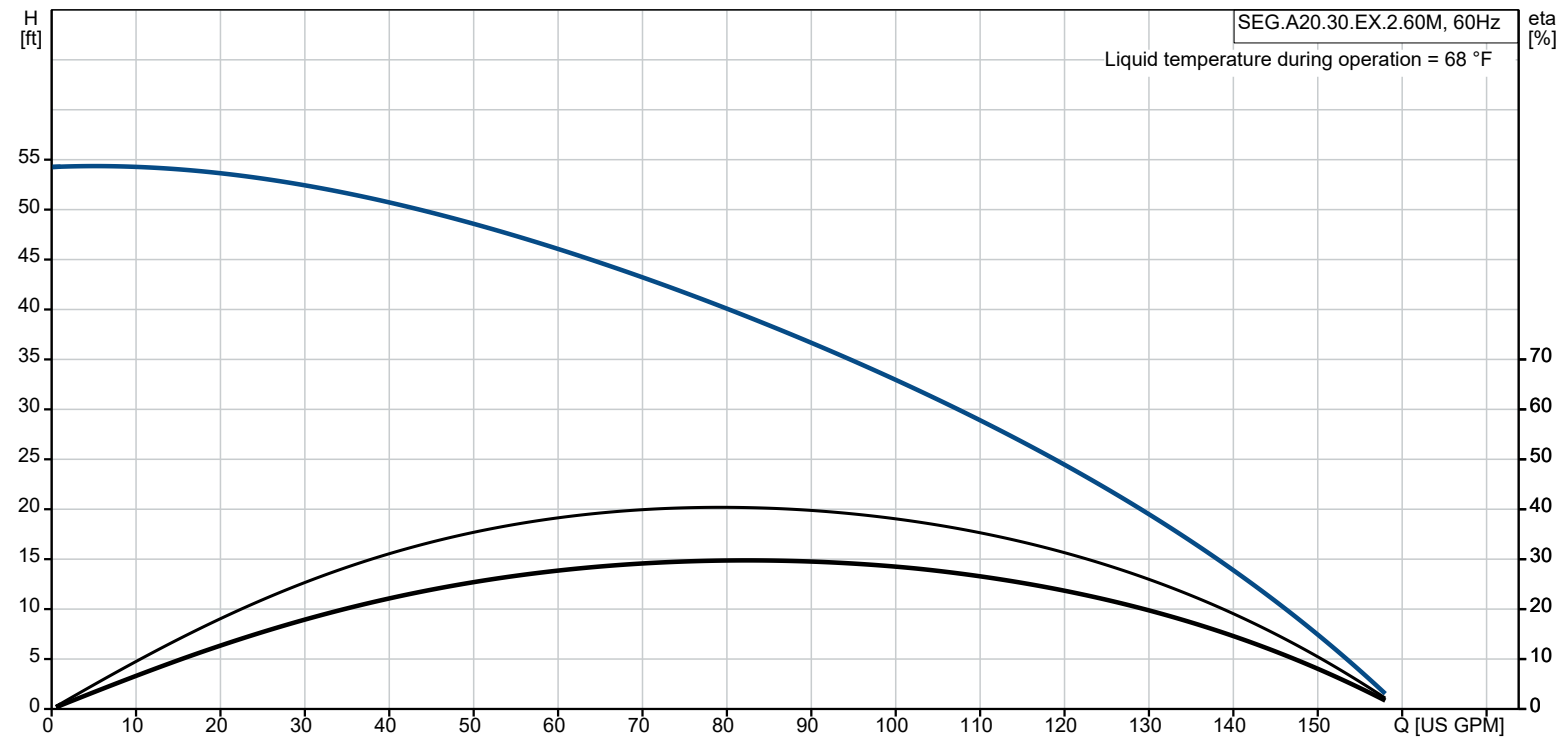

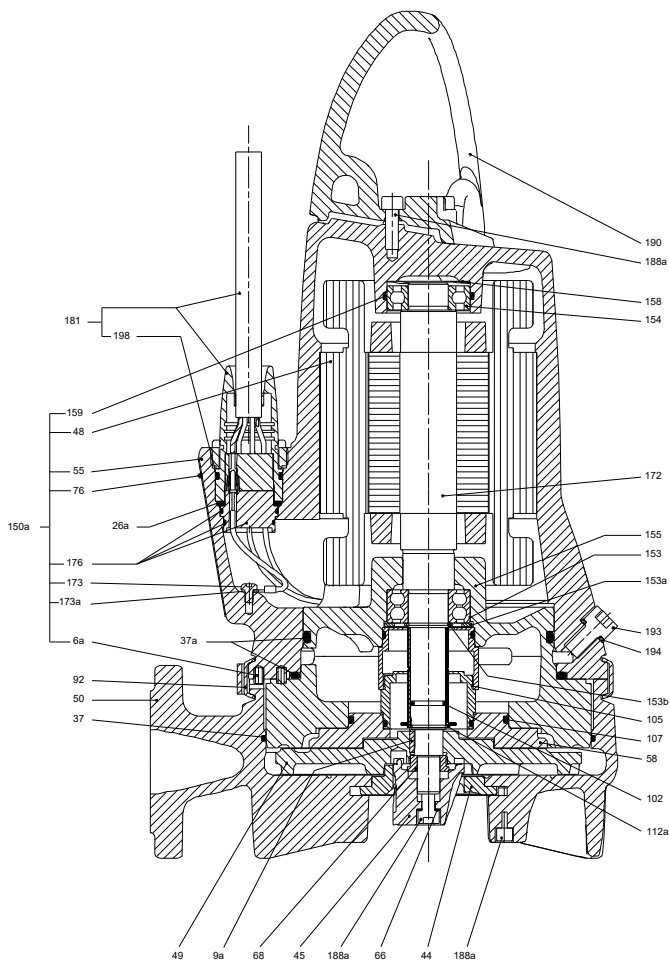
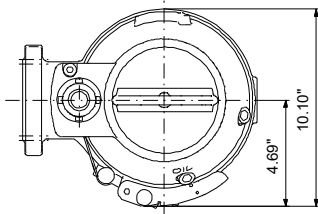
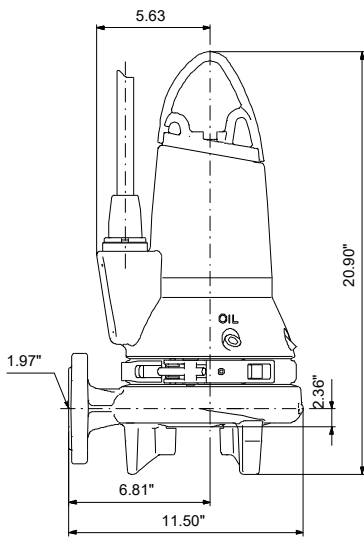

Materials:

- Pump housing: Cast iron
- Pump housing: EN1561 EN-GJL-200
- Pump housing: ASTM ASTM A48 30B
- Impeller: Cast iron
- Impeller: EN1561 EN-GJL-200
- Impeller: ASTM ASTM A48 30B

Qty.	Description
------	-------------

1	SEG.A20.30.EX.2.60M
---	----------------------------



Note! Product picture may differ from actual product

Product No.: [98280862](#)

Grundfos SEG grinder pumps are non-self-priming, single-stage, centrifugal pumps with horizontal discharge port, specifically designed for pumping wastewater containing discharge from toilets. The pump is equipped with a grinder system that grinds destructible solids into small pieces to lead them through pipes with a relatively small diameter.

SEG grinder pumps are ideal for use in sparsely populated areas, where gravity sewage systems are not available. Examples include villages, farm areas and areas with large terrain-level differences, where a pressurised system has advantages.

The pump is available for two types of installation:

- submerged installation on auto-coupling systems
- submerged installation, free-standing.

The pump is made of wear-resistant materials, such as cast iron and stainless steel.

These materials ensure reliable operation.

The surface of the pump is smooth to prevent dirt and impurities from sticking.

The corrosion-resistant stainless steel clamp is securing the motor to the pump housing and allow the easy service of the pump.

SmartTrim system allows easy adjustment of the impeller clearance to ensure maximum efficiency during the pump lifespan.

The range is designed to reduce energy consumption and keep downtime costs to a minimum, while maintaining peak performance throughout the lifespan of the system.

Further product details

This grinder pump is specially designed for pumping effluent and untreated domestic sewage in areas with no sewer system or where gravitation systems are unsuitable.

The pump is designed for transfer of domestic and municipal wastewater:

- in sparsely populated areas
- in small villages and farms
- in areas of difficult topography
- in areas with high groundwater

The pump can also remove industrial wastewater containing fibres in industrial applications, such as washing plants.

Pump

The pump is primarily made of cast iron with surface treatment of powder coating: black NCS9000N/RAL 9005, gloss 30, thickness 100 µ.

The pump features a patented grinder system, ensuring extremely high efficiency and reliable operation. Quick and easy dismantling for replacement of wear parts. No special tools are required.

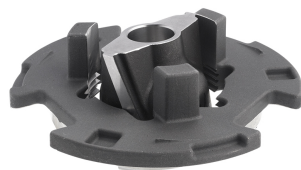

A stainless-steel clamp connection between motor and pump housing ensures easy inspection and service of the impeller and shaft seal.

This pump is equipped with the unique SmartTrim system that enables you to easily restore the factory-set impeller clearance and maintain peak pumping efficiency.

To do this, remove the cutter head and adjust the SmartTrim nut on the impeller.

This can be done on site without dismantling the pump and without using special tools.

Qty.	Description																																																																												
1	<p>The pump has been tested and approved by CSA.</p> <p>Motor</p> <p>The motor is a watertight, totally encapsulated motor, supplied with a 33 ft power cable. The stainless-steel plug is fastened with a union nut. This nut and O-rings provide sealing against ingress of the liquid. The plug is polyurethane-embedded, ensuring a watertight and durable seal around the leads of the cable. This prevents the ingress of water into the motor through the cable in case of cable breakage or adverse handling in connection with installation or service.</p> <p>The motor construction is compact with a short shaft. This reduces vibrations, resulting in an increased efficiency and life of the shaft seal and ball bearings. The motor has two thermal switches in the motor windings to protect the motor against overheating.</p> <p>Controls:</p> <table data-bbox="79 604 718 694"> <tr> <td>Moisture sensor:</td> <td>Y</td> </tr> <tr> <td>AUTOADAPT:</td> <td>No</td> </tr> </table> <p>Liquid:</p> <table data-bbox="79 716 718 840"> <tr> <td>Liquid temperature range:</td> <td>32 .. 104 °F</td> </tr> <tr> <td>Selected liquid temperature:</td> <td>68 °F</td> </tr> <tr> <td>Density:</td> <td>62.29 lb/ft³</td> </tr> </table> <p>Technical:</p> <table data-bbox="79 873 718 1019"> <tr> <td>Type of impeller:</td> <td>GRINDER SYSTEM</td> </tr> <tr> <td>Primary shaft seal:</td> <td>SIC/SIC</td> </tr> <tr> <td>Approvals:</td> <td>CSA, FM</td> </tr> <tr> <td>Curve tolerance:</td> <td>ANSI/HI11.6:2017 3B2</td> </tr> </table> <p>Materials:</p> <table data-bbox="79 1052 718 1265"> <tr> <td>Pump housing:</td> <td>Cast iron EN1561 EN-GJL-200 ASTM ASTM A48 30B</td> </tr> <tr> <td>Impeller:</td> <td>Cast iron EN1561 EN-GJL-200 ASTM ASTM A48 30B</td> </tr> </table> <p>Installation:</p> <table data-bbox="79 1299 718 1568"> <tr> <td>Maximum ambient temperature:</td> <td>104 °F</td> </tr> <tr> <td>Maximum operating pressure:</td> <td>87.02 psi</td> </tr> <tr> <td>Flange standard:</td> <td>ANSI</td> </tr> <tr> <td>Pipework connection:</td> <td>2"</td> </tr> <tr> <td>Size of outlet connection:</td> <td>2 inch</td> </tr> <tr> <td>Pressure rating:</td> <td>PN 10</td> </tr> <tr> <td>Maximum installation depth:</td> <td>32.8 ft</td> </tr> <tr> <td>Auto-coupling:</td> <td>98245790</td> </tr> </table> <p>Electrical data:</p> <table data-bbox="79 1601 718 2213"> <tr> <td>Power input - P1:</td> <td>2.8 kW</td> </tr> <tr> <td>Rated power - P2:</td> <td>3 HP</td> </tr> <tr> <td>Mains frequency:</td> <td>60 Hz</td> </tr> <tr> <td>Rated voltage:</td> <td>3 x 200-230 V</td> </tr> <tr> <td>Voltage tolerance:</td> <td>+6/-10 %</td> </tr> <tr> <td>Max starts per hour:</td> <td>30</td> </tr> <tr> <td>Rated current:</td> <td>10-9 A</td> </tr> <tr> <td>Starting current:</td> <td>65 A</td> </tr> <tr> <td>Rated current at no load:</td> <td>4.6 A</td> </tr> <tr> <td>Cos phi - power factor:</td> <td>0.84</td> </tr> <tr> <td>Cos phi - p.f. at 3/4 load:</td> <td>0.81</td> </tr> <tr> <td>Cos phi - p.f. at 1/2 load:</td> <td>0.7</td> </tr> <tr> <td>Rated speed:</td> <td>3500 rpm</td> </tr> <tr> <td>Moment of inertia:</td> <td>0.335 lb ft²</td> </tr> <tr> <td>Motor efficiency at full load:</td> <td>78 %</td> </tr> <tr> <td>Motor efficiency at 3/4 load:</td> <td>75 %</td> </tr> <tr> <td>Motor efficiency at 1/2 load:</td> <td>70 %</td> </tr> <tr> <td>Number of poles:</td> <td>2</td> </tr> <tr> <td>Start. method:</td> <td>DOL</td> </tr> </table>	Moisture sensor:	Y	AUTOADAPT:	No	Liquid temperature range:	32 .. 104 °F	Selected liquid temperature:	68 °F	Density:	62.29 lb/ft³	Type of impeller:	GRINDER SYSTEM	Primary shaft seal:	SIC/SIC	Approvals:	CSA, FM	Curve tolerance:	ANSI/HI11.6:2017 3B2	Pump housing:	Cast iron EN1561 EN-GJL-200 ASTM ASTM A48 30B	Impeller:	Cast iron EN1561 EN-GJL-200 ASTM ASTM A48 30B	Maximum ambient temperature:	104 °F	Maximum operating pressure:	87.02 psi	Flange standard:	ANSI	Pipework connection:	2"	Size of outlet connection:	2 inch	Pressure rating:	PN 10	Maximum installation depth:	32.8 ft	Auto-coupling:	98245790	Power input - P1:	2.8 kW	Rated power - P2:	3 HP	Mains frequency:	60 Hz	Rated voltage:	3 x 200-230 V	Voltage tolerance:	+6/-10 %	Max starts per hour:	30	Rated current:	10-9 A	Starting current:	65 A	Rated current at no load:	4.6 A	Cos phi - power factor:	0.84	Cos phi - p.f. at 3/4 load:	0.81	Cos phi - p.f. at 1/2 load:	0.7	Rated speed:	3500 rpm	Moment of inertia:	0.335 lb ft²	Motor efficiency at full load:	78 %	Motor efficiency at 3/4 load:	75 %	Motor efficiency at 1/2 load:	70 %	Number of poles:	2	Start. method:	DOL
Moisture sensor:	Y																																																																												
AUTOADAPT:	No																																																																												
Liquid temperature range:	32 .. 104 °F																																																																												
Selected liquid temperature:	68 °F																																																																												
Density:	62.29 lb/ft³																																																																												
Type of impeller:	GRINDER SYSTEM																																																																												
Primary shaft seal:	SIC/SIC																																																																												
Approvals:	CSA, FM																																																																												
Curve tolerance:	ANSI/HI11.6:2017 3B2																																																																												
Pump housing:	Cast iron EN1561 EN-GJL-200 ASTM ASTM A48 30B																																																																												
Impeller:	Cast iron EN1561 EN-GJL-200 ASTM ASTM A48 30B																																																																												
Maximum ambient temperature:	104 °F																																																																												
Maximum operating pressure:	87.02 psi																																																																												
Flange standard:	ANSI																																																																												
Pipework connection:	2"																																																																												
Size of outlet connection:	2 inch																																																																												
Pressure rating:	PN 10																																																																												
Maximum installation depth:	32.8 ft																																																																												
Auto-coupling:	98245790																																																																												
Power input - P1:	2.8 kW																																																																												
Rated power - P2:	3 HP																																																																												
Mains frequency:	60 Hz																																																																												
Rated voltage:	3 x 200-230 V																																																																												
Voltage tolerance:	+6/-10 %																																																																												
Max starts per hour:	30																																																																												
Rated current:	10-9 A																																																																												
Starting current:	65 A																																																																												
Rated current at no load:	4.6 A																																																																												
Cos phi - power factor:	0.84																																																																												
Cos phi - p.f. at 3/4 load:	0.81																																																																												
Cos phi - p.f. at 1/2 load:	0.7																																																																												
Rated speed:	3500 rpm																																																																												
Moment of inertia:	0.335 lb ft²																																																																												
Motor efficiency at full load:	78 %																																																																												
Motor efficiency at 3/4 load:	75 %																																																																												
Motor efficiency at 1/2 load:	70 %																																																																												
Number of poles:	2																																																																												
Start. method:	DOL																																																																												



Company name:

Created by:

Phone:

Date:

07/05/2024

Qty. | Description

1	Enclosure class (IEC 34-5):	IP68
	Insulation class (IEC 85):	F
	Explosion proof:	yes
	Length of cable:	33 ft
	Cable type:	SEOOW 600V
	Type of cable plug:	No plug
	Others:	
	Net weight:	179 lb
	Country of origin:	HU
	Custom tariff no.:	8413.70.2004

Description	Value
General information:	
Product name:	SEG.A20.30.EX.2.60M
Product No:	98280862
EAN number:	5711492381366
Price:	
Technical:	
Max flow:	158 US GPM
Head max:	55.12 ft
Type of impeller:	GRINDER SYSTEM
Primary shaft seal:	SIC/SIC
Approvals:	CSA, FM
Curve tolerance:	ANSI/HI11.6:2017 3B2
Materials:	
Pump housing:	Cast iron
Pump housing:	EN1561 EN-GJL-200
Pump housing:	ASTM ASTM A48 30B
Impeller:	Cast iron
Impeller:	EN1561 EN-GJL-200
Impeller:	ASTM ASTM A48 30B
Installation:	
Maximum ambient temperature:	104 °F
Maximum operating pressure:	87.02 psi
Flange standard:	ANSI
Pipework connection:	2"
Size of outlet connection:	2 inch
Pressure rating:	PN 10
Maximum installation depth:	32.8 ft
Inst dry/wet:	SUBMERGED
Auto-coupling:	98245790
Liquid:	
Liquid temperature range:	32 .. 104 °F
Selected liquid temperature:	68 °F
Density:	62.29 lb/ft³
Electrical data:	
Power input - P1:	2.8 kW
Rated power - P2:	3 HP
Mains frequency:	60 Hz
Rated voltage:	3 x 200-230 V
Voltage tolerance:	+6/-10 %
Max starts per hour:	30
Rated current:	10-9 A
Starting current:	65 A
Rated current at no load:	4.6 A
Cos phi - power factor:	0.84
Cos phi - p.f. at 3/4 load:	0.81
Cos phi - p.f. at 1/2 load:	0.7
Rated speed:	3500 rpm
Moment of inertia:	0.335 lb ft²
Motor efficiency at full load:	78 %
Motor efficiency at 3/4 load:	75 %
Motor efficiency at 1/2 load:	70 %
Number of poles:	2
Start. method:	DOL
Enclosure class (IEC 34-5):	IP68
Insulation class (IEC 85):	F
Explosion proof:	yes
Built-in motor protection:	THERMAL SWITCH
Thermal protec:	EXT.
Length of cable:	33 ft
Cable type:	SEOOW 600V
Type of cable plug:	No plug
Controls:	
Control box:	N
Additional I/O:	External
Moisture sensor:	Y

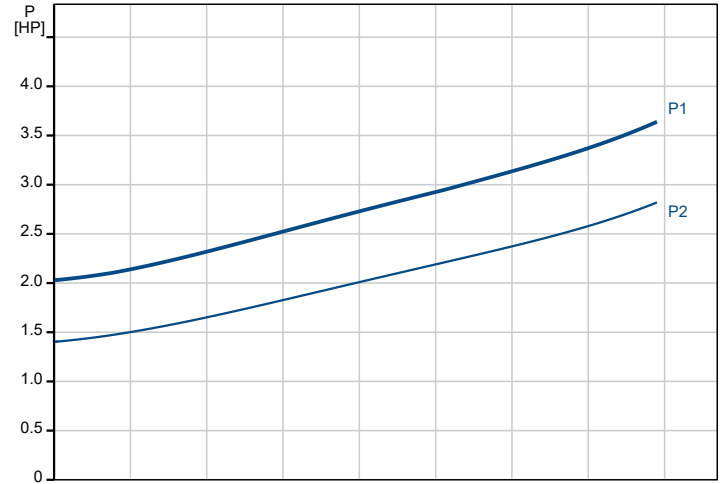
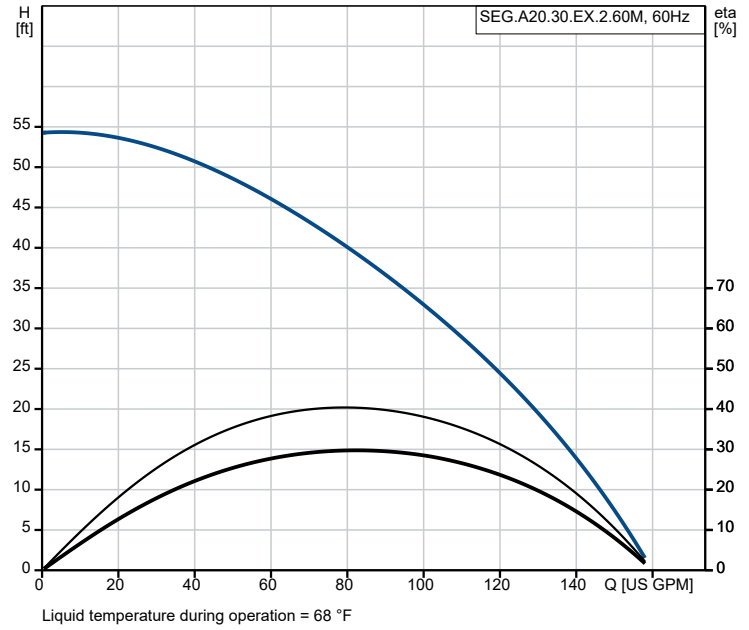



Company name:

Created by:

Phone:

Date:

07/05/2024

Description	Value
AUTOADAPT:	No
Others:	
Net weight:	179 lb
Sales region:	NAMREG
Country of origin:	HU
Custom tariff no.:	8413.70.2004

98280862 SEG.A20.30.EX.2.60M 60 Hz

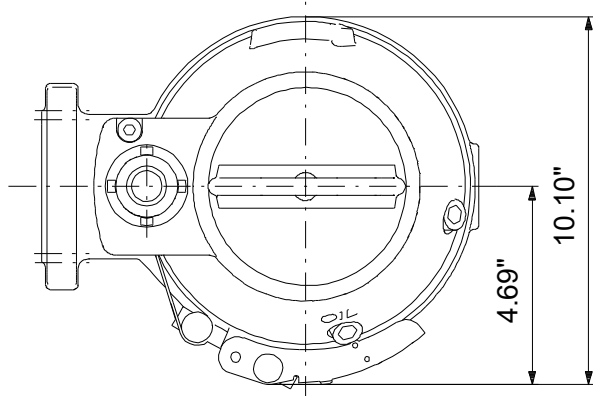
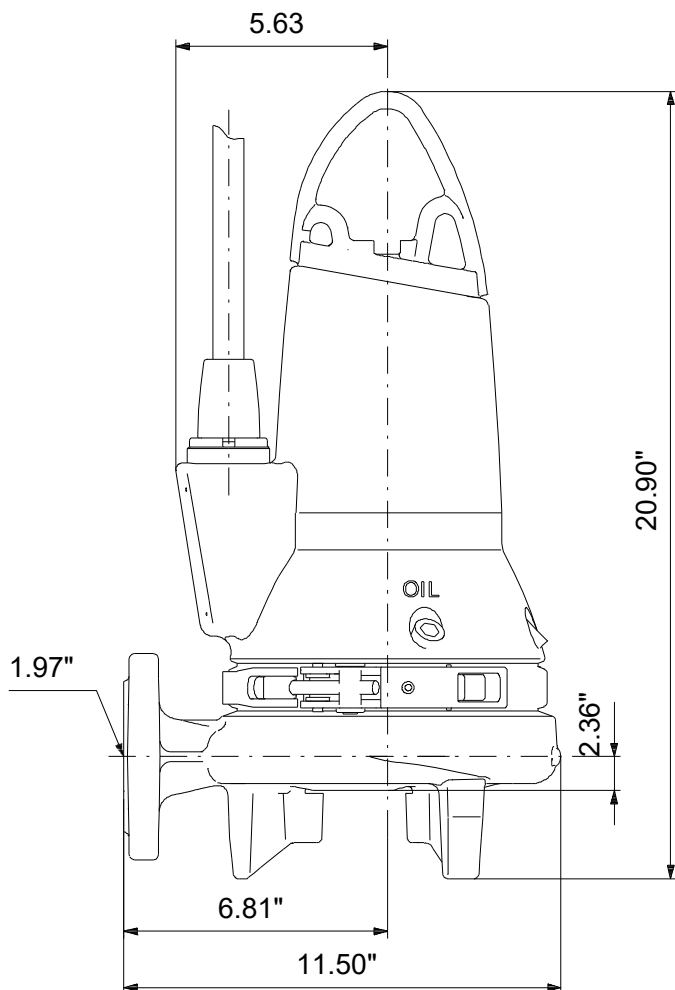

98280862 SEG.A20.30.EX.2.60M 60 Hz

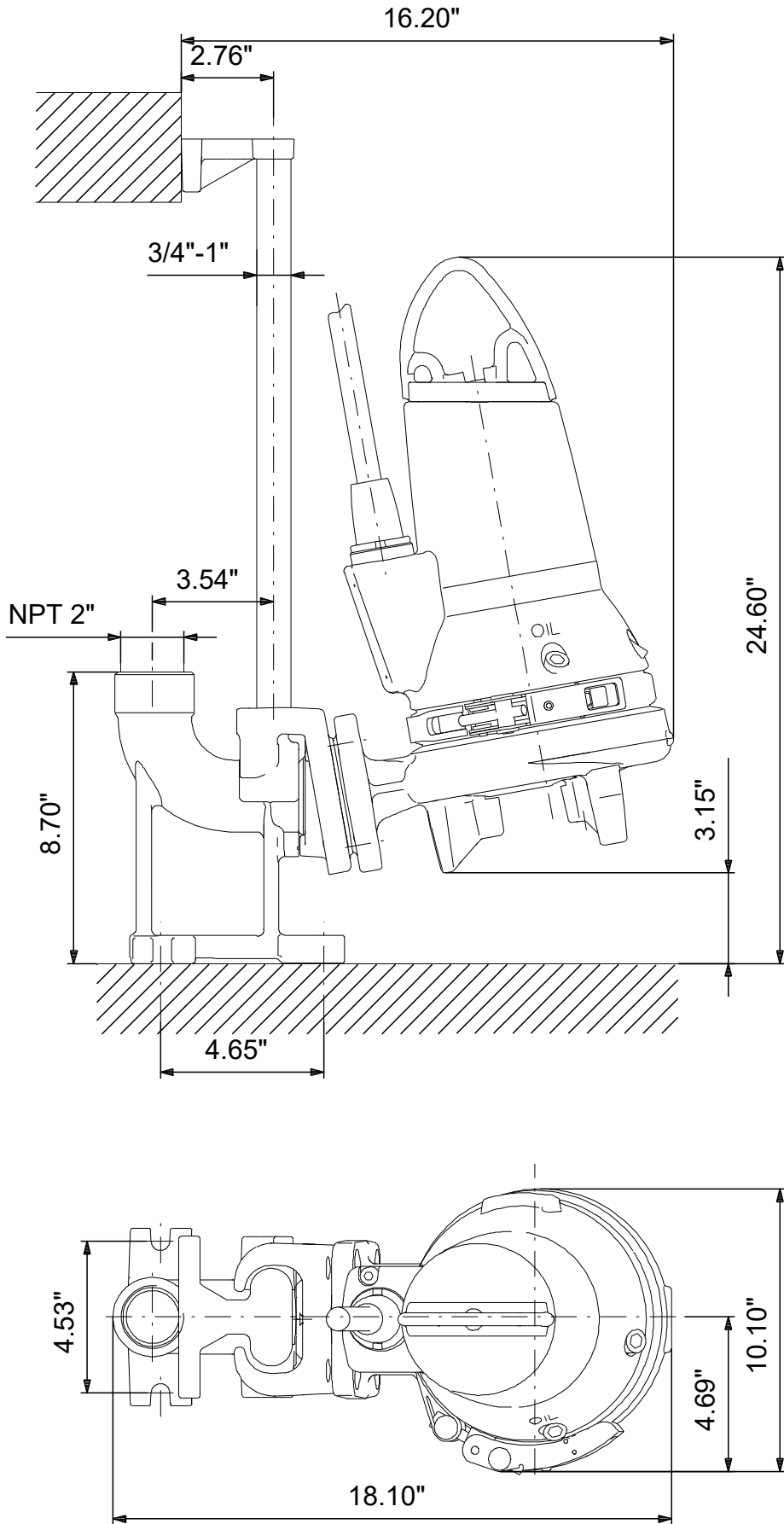

Note! All units are in [in] unless others are stated.
Disclaimer: This simplified dimensional drawing does not show all details.

98280862 SEG.A20.30.EX.2.60M 60 Hz

