

# SPECIFICATION AND INSTALLATION GUIDE

## CA2 Adapter for 24" Corrugated Pipe Riser

For use with grease interceptor models GB-50, GB-75, GB-250, GB-500, GB-1000, and GB-1500; solids interceptor models SI-50, SI-75, SI-250 and SI-500; sampling port models SV24 and SV24-O.

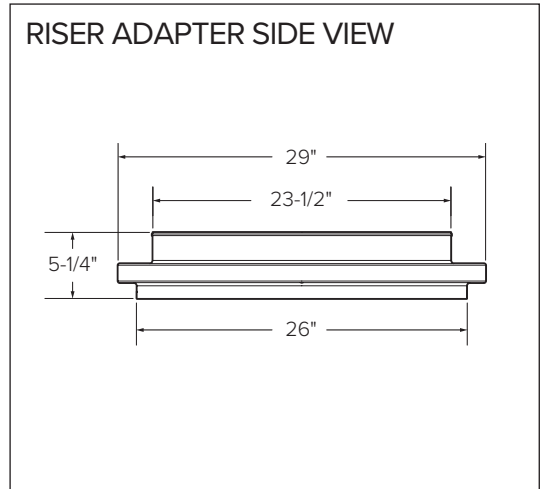
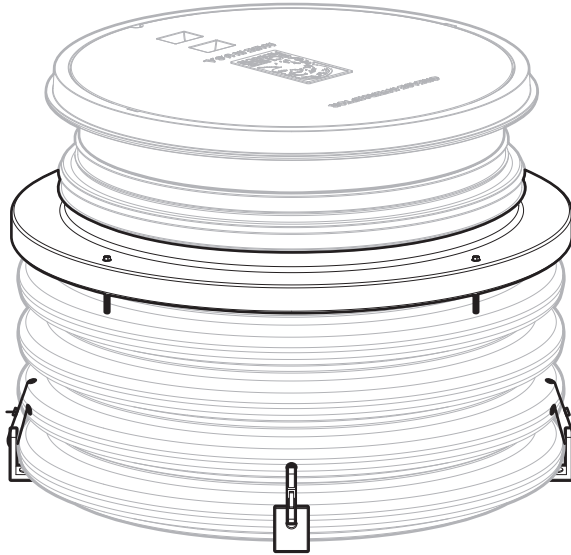

### Contents

Specifications .....	1
Special Precautions .....	2
Getting to Know the CA2 .....	3
Installation .....	4-7

### Notes

1. Unit weight: 22 lbs.
2. Riser not designed to hold water

### Engineer Specification Guide:

24" corrugated pipe riser adapter system to consist of rotomolded polyethylene riser adapter, butyl mastic sealant for tank-riser and riser-adapter joints, corrosion resistant steel fastening hardware and heavy-duty nylon cable ties.

### Installation Note

Corrugated riser system must be a minimum height of 6" and not exceed a height of 94". Access to internal components will not be compromised.



**SCHIER**

MODEL NUMBER:

**CA2**

DESCRIPTION: Adapter for 24" Corrugated Pipe Riser

PART #: 8010-011-01

DATE: 06/01/2024

REV:

ECO:



# SPECIAL PRECAUTIONS

For Schier Interceptor Installations - Failure to follow this guidance voids your warranty

**WARNING!** DO NOT AIR TEST UNIT OR RISER SYSTEM!  
Doing so may result in property damage, personal injury or death.

**CAUTION!** Do not install this unit in any manner except as described in these instructions.

Read all instructions before installation

Install in conformance with all local codes

## Below Grade Installation Slab Requirements

A concrete slab to finished grade with rebar is required when installing interceptor below grade.

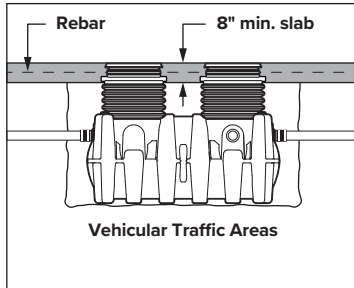
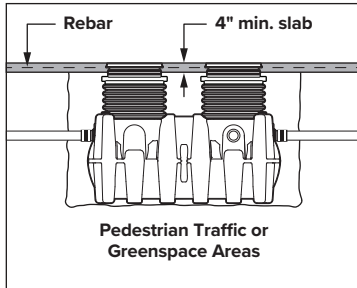

## Hydrostatic/ Pressure Slabs

When installed under a hydrostatic slab (slab designed to withstand upward lift, usually caused by hydrostatic pressure) interceptor must be enclosed in a watertight concrete vault.

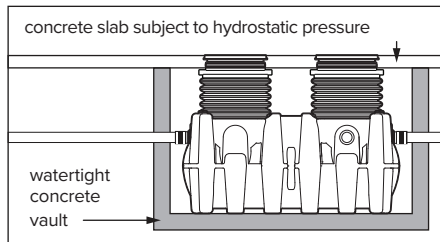

## High Water Table Installations

Interceptors and risers are not designed to withstand water table height in excess of the top of the unit when buried (see figure). If it is possible for this to occur, install the interceptor and risers in a water-tight concrete vault or backfill with concrete or flowable fill (wet concrete and flowable backfill should be poured in stages to avoid crushing the interceptor). At risk areas include but are not limited to tidal surge areas, floodplains and areas that receive storm water. Great Basin™ models that are direct buried in high water table scenarios must be installed with an anchor kit.

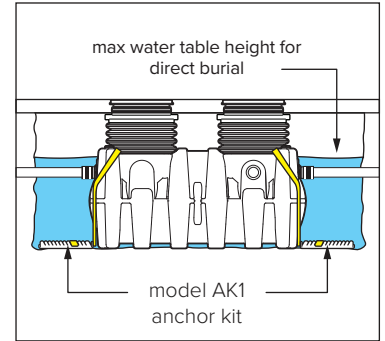

**DO NOT COMPACT BACKFILL**

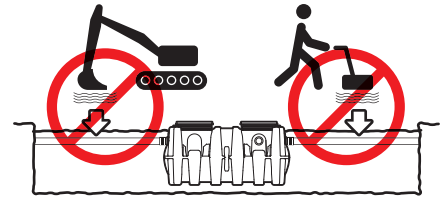

## 6" Minimum Riser Height

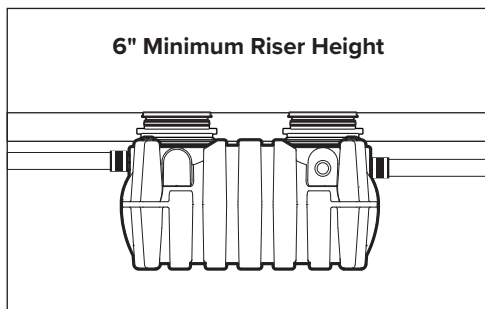

## Maximum Riser Height

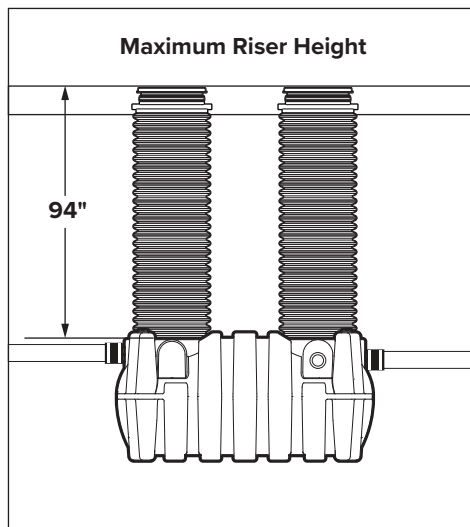

## Max Water Level

Risers are not designed to retain water

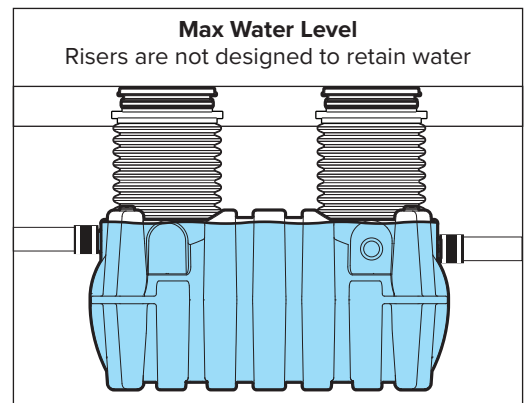

**Make Sure Parts Are Clean When Applying Mastic Sealant**

## CAUTION

Do not add any form of lubricant to riser tube during installation.

# GETTING TO KNOW THE CA2

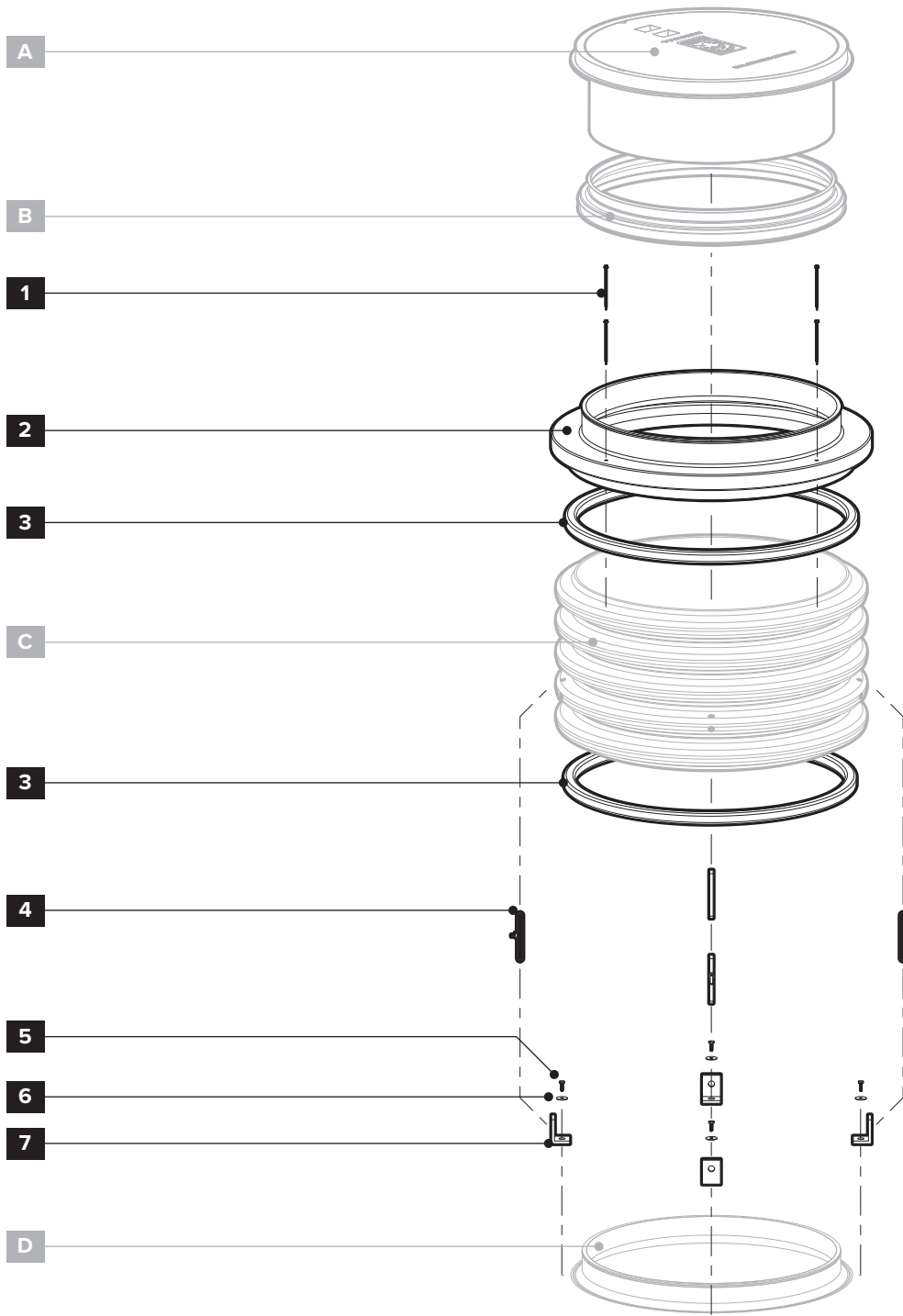

## Included with CA2

- |  |  |
|--|--|
| <ol style="list-style-type: none"> <li>1. #12 x 4" self tapping screws (x4)</li> <li>2. Riser adapter</li> <li>3. 1" square x 80" block butyl mastic sealant (x2)</li> </ol> | <ol style="list-style-type: none"> <li>4. Heavy duty 18" - 120 lb. cable tie (x4)</li> <li>5. 1/4"-20 x 5/8" hexhead bolt (x4)</li> <li>6. 1/4" ID oversized washer (x4)</li> <li>7. 90° angle bracket (x4)</li> </ol> |
|--|--|

## Not Included

- A. Cover adapter (with cover)
- B. Cover adapter gasket assembly
- C. 24" corrugated pipe riser (by others)
- D. Interceptor accessway

# INSTALLATION

## Tools You Will Need



Tape Measure



Reciprocating Saw, Circular Saw or Jigsaw



Drill with 1/2" Chuck



Level



3/8" Drill Bit



5/16" Socket Driver

### INCLUDED WITH INTERCEPTOR



7/16" Nut Driver Bit

## 1 Determine riser height and cut 24" corrugated pipe.

- 1a** With cover adapter in the factory set position, measure dimension X to determine riser height needed.

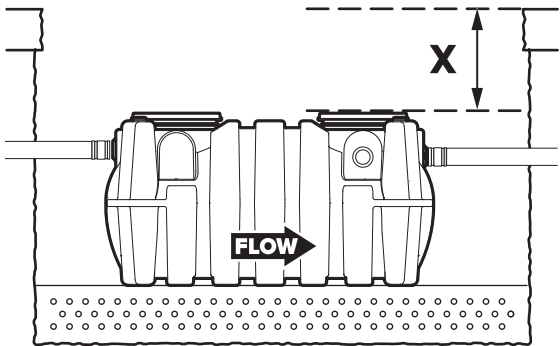

- 1b** Subtract 4" from riser height needed to determine corrugated pipe trim height. Mark and cut corrugated pipe.

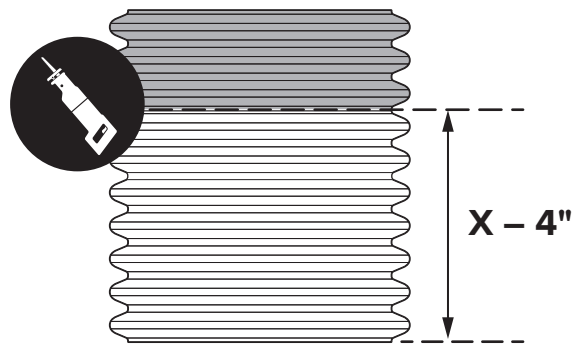

**NOTE:** Trimming riser using these guidelines will result in a riser that is roughly 1-1/2" shorter than the exact riser height needed. Cover Adapter adjustability will allow for final adjustments to grade.

# INSTALLATION

## 2 Install riser onto grease interceptor.

2a

Loosen the Cover Adapter Lower Band Clamps using 7/16" Nut Driver Bit.

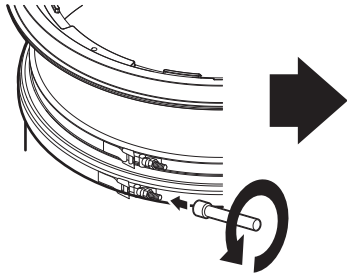

2b

Remove Cover Adapters

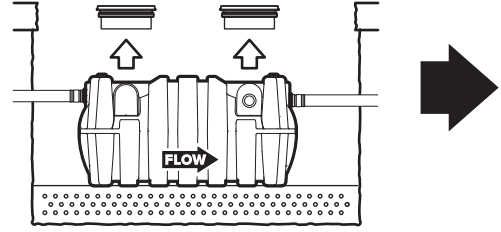

2c

Remove plugs from the 4 threaded inserts around the interceptor accessway. Use a 7/16" nut driver to attach the angle brackets as shown with the 1/4"-20 hex bolts and oversized 1/4" washers.

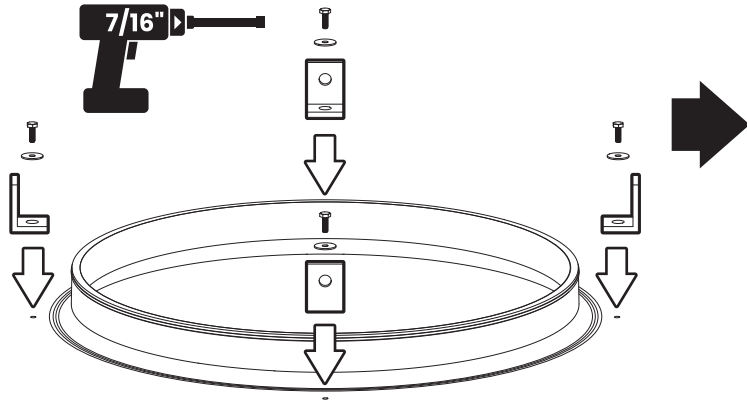

2d

Lay Butyl Mastic sealant into the channel surrounding the accessway, aligned on center with the inner wall of the riser.

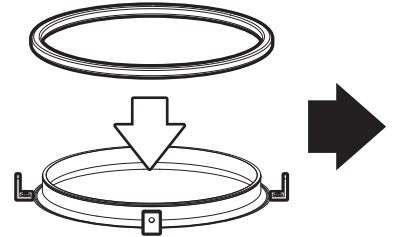

2e

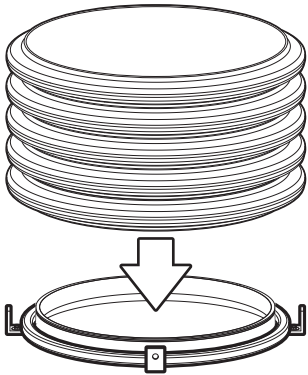

Place Riser Into position and press firmly into mastic seal.

2f

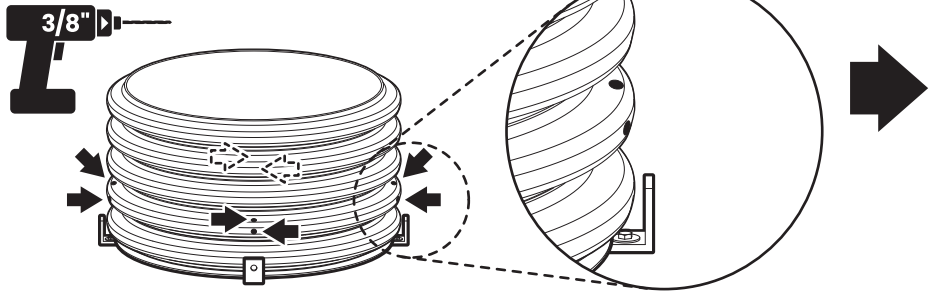

Drill 4 pairs of 3/8" holes in the outer wall of the riser above each angle bracket as shown - one hole in the sidewall and one hole on the top edge of the first rib above the angle brackets.

2g

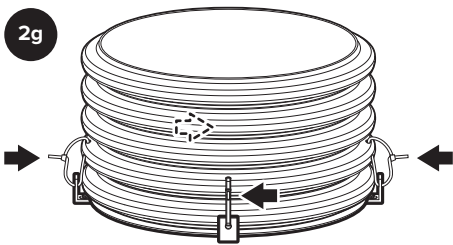

Loop Cable Ties through holes drilled in the riser rib and the angle brackets, do not tighten

2h

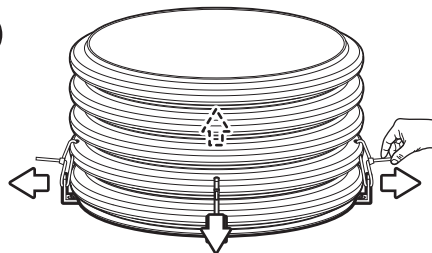

Tighten Cable Ties, a little bit at a time going around the riser to evenly force the riser into the Mastic Sealant. Do not tighten completely to allow some room for final adjustments.

Tightening Pattern

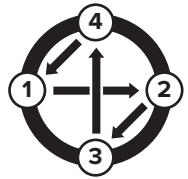

# INSTALLATION

## 3 Install riser adapter onto riser.

3a

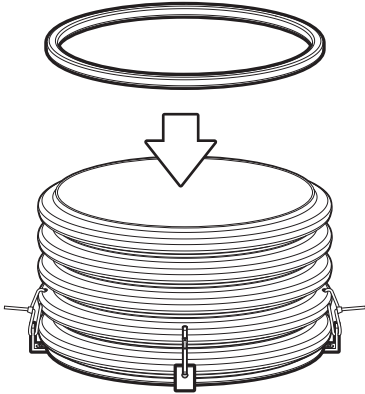

Lay Butyl Mastic sealant onto the top rib of the corrugated riser pipe as shown, aligned on center with the bottom edge of the Riser Adapter.

3b

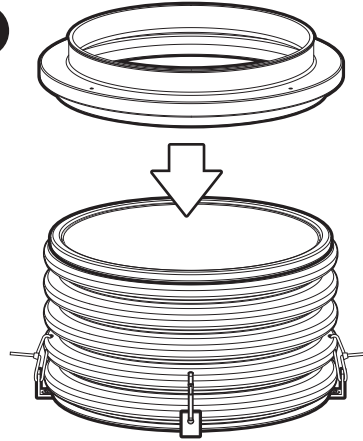

Place Riser Adapter Into position and press firmly into the mastic sealant.

3c

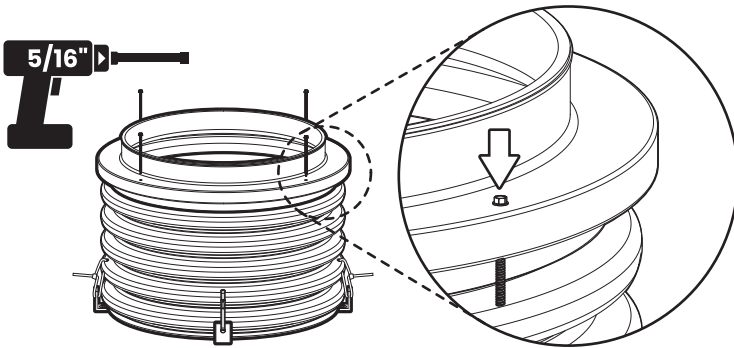

Secure Riser Adapter to Riser Pipe using (4) #12 x 4" self tapping screws. Insert screws into pre-drilled holes in Riser Adapter and drill/screw into the riser rib as shown using a 5/16" socket driver.

3d

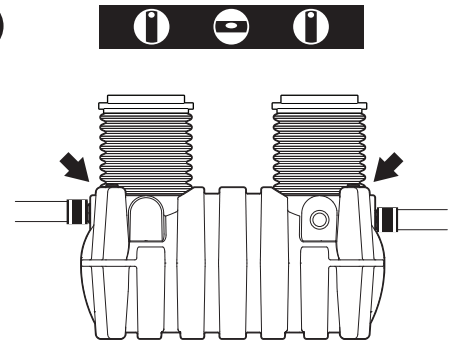

Make final tightening adjustments to cable ties to ensure riser is level.

# INSTALLATION

## 4 Install cover adapters onto risers.

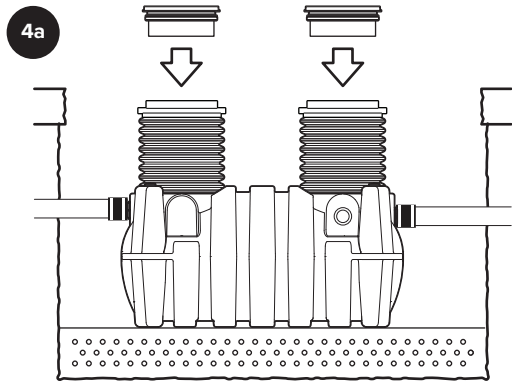

Place Cover Adapter / Gasket Assembly onto top of riser system.



Tighten **Lower** Band Clamp to 5 -8 ft. lbs. of torque using 7/16" Nut Driver Bit.

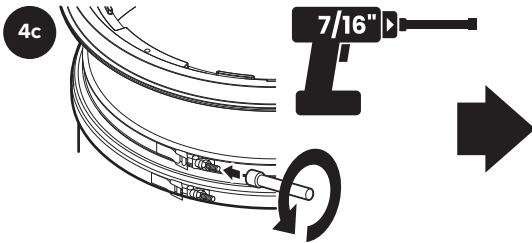

Loosen the Cover Adapter **Upper** Band Clamp using 7/16" Nut Driver Bit.

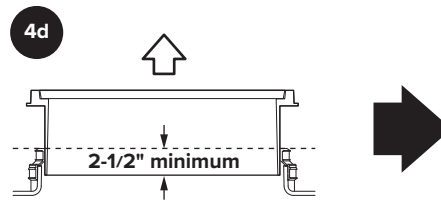

Adjust Cover Adapter height as needed to bring cover flush to grade. **Maintain a minimum 2-1/2" insertion depth.**

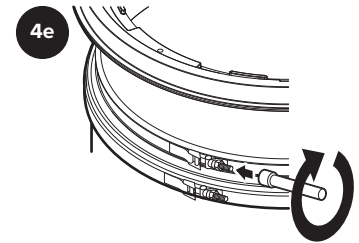

Tighten Upper Band Clamp to 5 -8 ft. lbs. of torque using 7/16" Nut Driver Bit.