

**EPOXY COATED**  
PROTECTIVE SHIELD SYSTEM

**RISER CLAMPS**

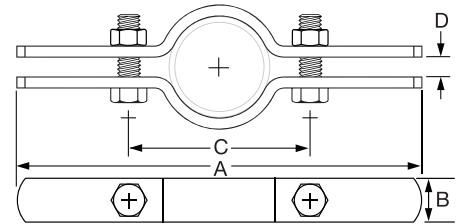

## STANDARD COPPER EPOXY COATED RISER CLAMPS

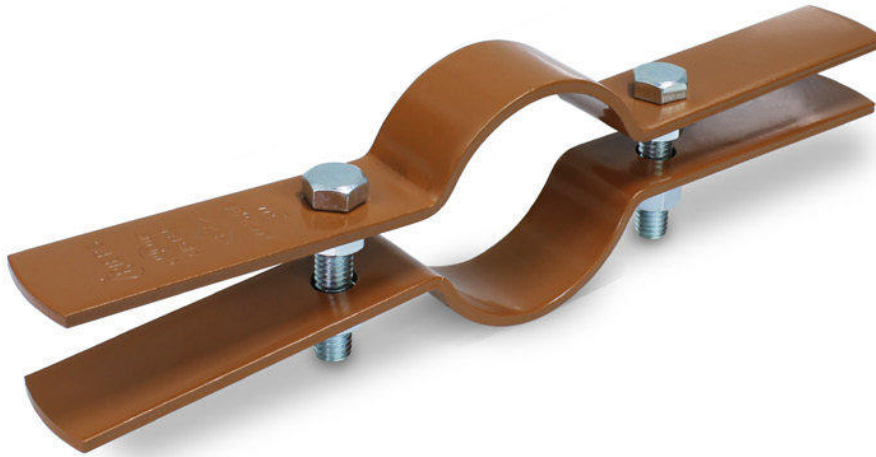

Designed for supporting and stabilizing vertical pipe

- Maximum temperature Plain 650° F, Galvanized 450° F
- Designed for standard iron and copper pipe
- Underwriters Laboratories Listed (UL) and Factory Mutual Approved (FM)
- Complies with Federal Specifications A-A-1192A Type 8, Manufacturers Standardization Society (MSS) ANSI/SP-69 and SP-58 Type 8

**Sizes:** 1/2" - 6"

**Material:** Carbon Steel

**Finish:** Copper Epoxy Coated

**Approvals:** UL, FM, Complies with A-A-1192A Type 8, ANSI/SP-69 & SP-58 Type 8

SIZE INCHES	ITEM COPPER EPOXY COATED	MAX LOAD LBS	WEIGHT LBS	A LENGTH	B WIDTH	C DISTANCE	D SPACE	BOLT SIZE	TORQUE VALUES	INNER BOX	MASTER BOX	PALLET QTY
1/2"	CLRS-EC12	220	0.8	8-1/2	1	2-21/64	15/64	3/8	19	10	50	2400
3/4"	CLRS-EC34	220	0.8	8-15/16	1	2-43/64	15/64	3/8	19	10	50	2400
1"	CLRS-EC01	220	1.04	8-15/16	1	2-51/64	25/64	3/8	19	10	50	2400
1-1/4"	CLRS-EC114	250	1.06	9-29/64	1	3-17/64	25/64	3/8	19	10	50	2400
1-1/2"	CLRS-EC112	250	1.08	9-7/8	1	3-47/64	5/8	3/8	19	10	50	2400
2"	CLRS-EC02	300	1.16	10-15/64	1-3/16	4-11/64	25/32	3/8	19	-	25	1200
2-1/2"	CLRS-EC212	400	1.32	11-1/32	1-3/16	4-7/8	25/32	3/8	19	-	25	1200
3"	CLRS-EC03	500	1.56	11-47/64	1-3/16	5-33/64	25/32	3/8	19	-	25	1200
4"	CLRS-EC04	750	1.7	12-63/64	1-3/16	6-39/64	25/32	1/2	50	-	20	720
5"	CLRS-EC05	1500	3.45	14-31/64	2	8-17/64	25/32	1/2	50	-	15	540
6"	CLRS-EC06	1600	3.7	15-63/64	2	9-39/64	25/32	1/2	50	-	10	360