

data sheet

70LF-200 series

solder bronze ball valve | lead-free



features

- lead-free* brass & bronze materials
- EZ-Solder™ lead-free* brass & bronze materials**
- distinctive white “lead-free” handle grip and blue “lead-free” hang tag
- RPTFE seats and stuffing box ring
- chromium plated ball
- 100% factory tested
- manufactured in the USA – BABA and BAA compliant

**70LF-2xx intended for soft solder installation using solders with melting temperature of < 500°F.

description

The “Apollo”® 70LF-200 series two-piece regular port ball valve has the same rugged features as the industry standard 70 series valves with the added advantage of DZR lead free* materials. The 70LF is ideal for plumbing and heating systems, including potable water. Trusted Apollo® performance with a wide range of popular options.

*lead-free: the wetted surfaces of this product shall contain no more than 0.25% lead by weighted average. Complies with Federal Public Law 111-380. ANSI 3rd party approved and listed.

size range

- 3/8" - 4"

configurations

- 70LF-200 series – standard
- 70LF-240 series – 316 ss ball & stem

connections

- threaded
- solder joint

approvals

- MSS SP-110
- NSF/ANSI/CAN 61 - water quality
- NSF/ANSI/CAN 372 - lead-free
- CSA B51 CRN: 0C10908.5C
- Buy American Act (BAA)
- Build America Buy America (BABA) Act



this specification is provided for reference only. we reserve the right to change any portion of this specification without notice and without incurring obligation to make such changes to Aalberts integrated piping systems products previously or subsequently sold.

Aalberts integrated piping systems

10715 Sikes Place / suite 200 / Charlotte / NC / 28277

aalberts-ips.us

component	material
body	lead-free bronze, ASTM B584, C89836
retainer	lead-free DZR brass, ASTM B927, C27451 (3/8" to 1") lead-free bronze, ASTM B584, C89836 (1 1/4" to 4")
ball	lead-free DZR brass, ASTM B927, C27451, chrome plated or A276-316 stainless steel
seat (2)	RPTFE
stem	lead-free DZR brass, ASTM B927, C27451 A276-316 stainless steel (3" only)
gland nut	lead-free DZR brass, ASTM B927, C27451
stem packing	MPTFE
lever and grip	steel, zinc plated w/ vinyl grip
lever nut	steel, zinc plated
stem bearing	RPTFE

performance rating

CWP	temperature	vacuum service
600 psig at 100°F	350°F (maximum temperature)	29 in. Hg

job name

job location

engineer

contractor

tag

PO#

rep

wholesaler dist

data sheet

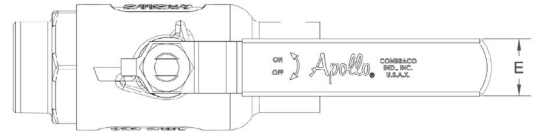
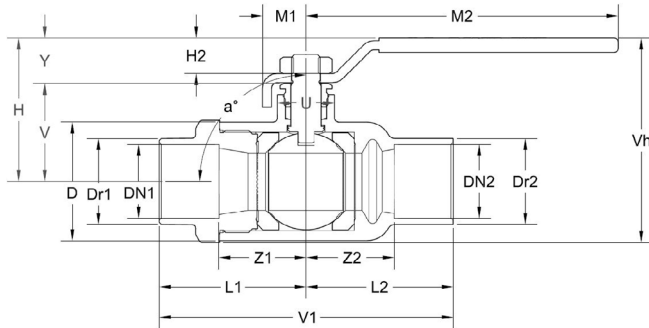

dimensions

part number	size	bore size	d1	d2	l1	l2	z1	z2	M1	M2	V	Y	weight
70LF-202-01	3/8"	0.37"	0.63"	0.63"	1.41"	1.42"	0.91"	0.92"	0.55"	3.85"	1.06"	0.65"	0.63 lbs
70LF-203-01	1/2"	0.50"	0.50"	0.50"	1.26"	1.28"	0.90"	0.91"	0.55"	3.85"	1.03"	0.65"	0.71 lbs
70LF-204-01	3/4"	0.68"	0.88"	0.88"	1.92"	1.93"	1.17"	1.18"	0.67"	4.76"	1.39"	0.68"	1.44 lbs
70LF-205-01	1"	0.87"	1.13"	1.13"	2.24"	2.24"	1.33"	1.34"	0.67"	4.76"	1.51"	0.68"	1.91 lbs
70LF-206-01	1 1/4"	1.00"	1.38"	1.38"	2.26"	2.30"	1.30"	1.34"	0.98"	5.40"	1.99"	0.70"	2.95 lbs
70LF-207-01	1 1/2"	1.25"	1.63"	1.63"	2.58"	2.61"	1.49"	1.52"	0.94"	7.75"	2.18"	3.07"	3.99 lbs
70LF-208-01	2"	1.50"	2.13"	2.13"	3.20"	3.13"	1.84"	1.79"	1.00"	7.75"	2.37"	0.90"	5.71 lbs
70LF-209-01	2 1/2"	2.00"	2.63"	2.63"	3.72"	3.78"	2.24"	2.30"	1.00"	7.75"	2.80"	0.90"	15.53 lbs
70LF-200-01	3"	2.50"	3.13"	3.13"	4.12"	4.12"	2.45"	2.45"	1.00"	7.75"	3.09"	0.90"	16.74 lbs
70LF-20A-01	4"	3.12"	4.13"	4.13"	5.66"	4.61"	3.50"	2.45"	1.35"	9.91"	3.94"	1.25"	27.93 lbs

options

option	component	size
(-04)	2 1/4" cs stem extension	3/8" - 3"
(-07)	steel tee handle	3/8" - 2"
(-10)	ss lever & nut	3/8" - 3"
(-11)	Therma-Seal™ insulating tee handle	3/8" - 2"
(-27)	ss latch-lock lever & nut	3/8" - 4"
(-48)	ss oval handle (no latch) & nut	3/8" - 2"
(-92)	balancing stop	3/8" - 3"
(-94)	2 1/4" stem extension & balancing stop	3/8" - 3"
(-HC)	hose thread w/ cap & chain	1/2" - 1"