

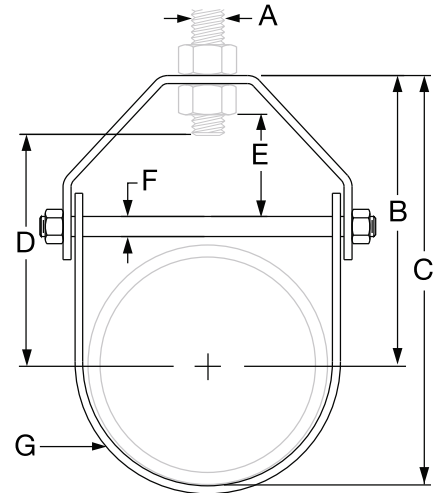

CLEVIS HANGERS



EPOXY COATED
PROTECTIVE SHIELD SYSTEM



COPPER EPOXY COATED CLEVIS



Designed for suspending pipe with vertical adjustment

- Maximum temperature 450° F
- Complies with Federal Specification WW-H-171 Type 1, Manufacturers Standardization Society (MSS) SP-69 Type 1
- When using insulated pipe, order hanger sized to correspond to overall dimension. It is also recommended to use insulation shields

Sizes: 1/2" - 6"

Material: Steel

Finish: Copper Epoxy Coated

Approvals: Complies with
MSS SP-69 Type 1,
WW-H-171 Type 1

SIZE INCHES	ITEM COPPER EPOXY COATED	MAX LOAD	WEIGHT	A ROD SIZE	B	C	D ROD OUT	E AJUSTMENT	F	G WIDTH LOWER	INNER BOX	MASTER BOX	PALLET QTY
1/2"	HCS-EC12	610	0.20	3/8	1-1/2	2-1/8	1-1/2	5/8	1/4	7/8	10	50	2400
3/4"	HCS-EC34	610	0.24	3/8	1-9/16	2-7/16	1-5/16	5/8	1/4	7/8	10	50	2400
1"	HCS-EC01	610	0.27	3/8	1-3/4	2-7/8	1-5/8	5/8	1/4	7/8	10	50	2400
1-1/4"	HCS-EC114	610	0.29	3/8	1-11/16	3-1/16	1-11/16	5/8	1/4	7/8	10	50	2400
1-1/2"	HCS-EC112	610	0.32	3/8	1-3/4	3-3/8	2-1/8	7/8	1/4	7/8	10	50	2400
2"	HCS-EC02	610	0.38	3/8	1-15/16	4-1/16	2-5/8	1-1/8	1/4	7/8	10	50	2440
2-1/2"	HCS-EC212	1130	0.61	1/2	3-1/8	5-13/16	3-3/16	1-5/16	1/4	1-1/32	-	30	1440
3"	HCS-EC03	1130	0.70	1/2	3-1/8	6-5/8	4-1/16	1-5/8	1/4	1-1/32	-	25	1200
3-1/2"	HCS-EC312	1130	0.75	1/2	3-1/8	6-15/16	4-3/8	1-5/8	1/4	1-1/32	-	25	600
4"	HCS-EC04	1130	0.78	1/2	3-3/8	7-3/8	4-1/2	1-11/16	1/4	1-1/32	-	25	600
5"	HCS-EC05	1430	1.89	5/8	3-5/16	8-1/2	5-1/2	1-15/16	3/8	1-1/4	-	25	400
6"	HCS-EC06	1940	2.06	5/8	3-5/8	8-13/16	5-3/4	1-11/16	3/8	1-1/4	-	10	240