

PRODUCT RANGE - REDUCING TEES(s)

aquatherm blue pipe® REDUCING TEE (REDUCER) (inlet, outlet, branch)

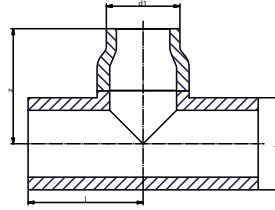

SDR	New Part no.	Old Part no.	Dimension (ND — OD)	d	d1	l	z	Weight
				[in]	[in]	[in]	[in, +0.25/-0.0]	[lb]
17.6	9792563655	2563655	12" x 12" x 8" — 315 x 315 x 200 mm	12.4	7.87	18.1	18.1	48.0
	9792563657	2563657	12" x 12" x 10" — 315 x 315 x 250 mm	12.4	9.84	18.1	18.1	44.5
	9792563669	2563669	14" x 14" x 10" — 355 x 355 x 250 mm	14.0	9.84	18.9	18.9	54.6
	9792563671	2563671	14" x 14" x 12" — 355 x 355 x 315 mm	14.0	12.4	18.9	18.9	58.6
	9792563684	2563684	16" x 16" x 12" — 400 x 400 x 315 mm	15.8	12.4	19.7	19.7	69.3
	9792563685	2563685	16" x 16" x 14" — 400 x 400 x 355 mm	15.8	14.0	19.7	19.7	68.6
	9792563699	2563699	18" x 18" x 14" — 450 x 450 x 355 mm	17.7	14.0	20.7	20.7	94.6
	9792563700	2563700	18" x 18" x 16" — 450 x 450 x 400 mm	17.7	15.8	20.7	20.7	93.8
	9792563813	2563813	20" x 20" x 14" — 500 x 500 x 355 mm	19.7	14.0	23.6	23.6	137
	9792563814	2563814	20" x 20" x 16" — 500 x 500 x 400 mm	19.7	15.8	23.6	23.6	137
	9792563815	2563815	20" x 20" x 18" — 500 x 500 x 450 mm	19.7	17.7	23.6	23.6	135
	9792563849	2563849	24" x 24" x 16" — 630 x 630 x 400 mm	24.8	15.8	26.2	26.2	246
	9792563850	2563850	24" x 24" x 18" — 630 x 630 x 450 mm	24.8	17.7	26.2	26.2	247
	9792563851	2563851	24" x 24" x 20" — 630 x 630 x 500 mm	24.8	19.7	26.2	26.2	242
11	9792063655	2063655	12" x 12" x 8" — 315 x 315 x 200 mm	12.4	7.87	18.1	18.1	66.3
	9792063657	2063657	12" x 12" x 10" — 315 x 315 x 250 mm	12.4	9.84	18.1	18.1	66.7
	9792063669	2063669	14" x 14" x 10" — 355 x 355 x 250 mm	14.0	9.84	18.9	18.9	83.9
	9792063671	2063671	14" x 14" x 12" — 355 x 355 x 315 mm	14.0	12.4	18.9	18.9	90.3
	9792063684	2063684	16" x 16" x 12" — 400 x 400 x 315 mm	15.8	12.4	19.7	19.7	108
	9792063685	2063685	16" x 16" x 14" — 400 x 400 x 355 mm	15.8	14.0	19.7	19.7	107
	9792063699	2063699	18" x 18" x 14" — 450 x 450 x 355 mm	17.7	14.0	20.7	20.7	146
	9792063700	2063700	18" x 18" x 16" — 450 x 450 x 400 mm	17.7	15.8	20.7	20.7	146
9	9790813908	0813908	12" x 12" x 8" — 315 x 315 x 200 mm	12.4	7.87	18.1	18.1	93.1
	9790813910	0813910	12" x 12" x 10" — 315 x 315 x 250 mm	12.4	9.84	18.1	18.1	94.6
	9790813922	0813922	14" x 14" x 10" — 355 x 355 x 250 mm	14.0	9.84	18.9	18.9	122.8
	9790813924	0813924	14" x 14" x 12" — 355 x 355 x 315 mm	14.0	12.4	18.9	18.9	122.2

^a4" branch is socket fusion. If needed, branch can come with a 1 ft extension to be used for butt-fusion.