

6. [Reducing Coupling (STYLE 25)] >>>

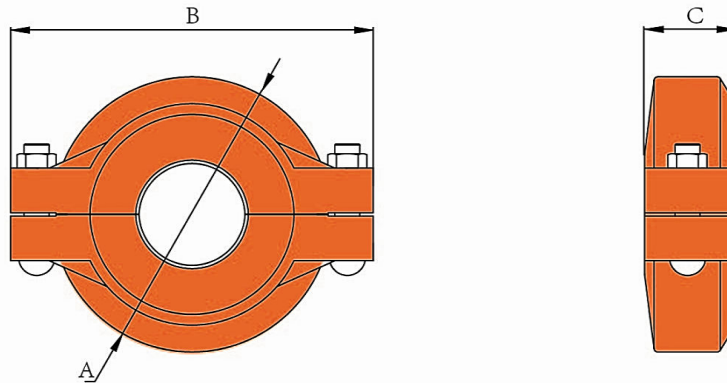

Pipe		Max Work press	Deflection from CL		Dimensions		
Size	O.D.		psi	degree	mm/m	A	B
inch	mm				in/mm	in/mm	in/mm
2"x1 1/2"	60.3x48.3	350	1° -53'	33.3	3.39/86	5/127	1.84/46.7
2 1/2"x2"	73x60.3	350	1° -33'	26.7	3.82/97	5.55/141	1.84/46.7
	76.1x60.3	350	1° -33'	26.7	4.13/105	5.87/149	1.84/46.7
3"x2"	88.9x60.3	350	1° -17'	22.4	4.57/116	6.42/163	1.84/46.7
3"x2 1/2"	88.9x73	350	1° -17'	22.4	4.57/116	6.42/163	1.84/46.7
	88.9x76.1	350	1° -17'	22.4	4.79/121	6.77/172	1.84/46.7
4"x2"	108x60.3	350	2° -38'	45.8	5.31/135	7.48/190	1.97/50
	114.3x60.3	350	2° -38'	45.8	5.98/152	7.72/196	1.97/50
4"x2 1/2"	108x73	350	2° -38'	45.8	5.31/135	7.48/190	1.97/50
	108x76.1	350	2° -38'	45.8	5.31/135	7.48/190	1.97/50
	114.3x73	350	2° -38'	45.8	5.87/149	7.72/196	1.97/50
	114.3x76.1	350	2° -38'	45.8	5.87/149	7.72/196	1.97/50
4"x3"	108x88.9	350	2° -38'	45.8	5.31/135	7.48/190	1.97/50
	114.3x88.9	350	2° -38'	45.8	5.83/148	7.99/203	1.97/50
6"x4"	159x108	350	1° -44'	30.2	7.48/190	10.75/273	2.05/52
	165.1x108	350	1° -44'	30.2	8.03/204	10.98/279	2.05/52
	165.1x114.3	350	1° -44'	30.2	8.03/204	10.98/279	2.05/52
	168.3x108	350	1° -44'	30.2	8.07/205	10.63/270	2.05/52
	168.3x114.3	350	1° -44'	30.2	8.07/205	10.63/270	2.05/52
6"x5"	165.1x140.3	350	1° -44'	30.2	7.99/203	11.26/286	2.05/52
	168.3x140.3	350	1° -44'	30.2	8.03/204	11.26/286	2.05/52
8"x6"	219x165.1	350	1° -15'	21.8	10.35/263	13.15/334	2.2/56
	219x168.3	350	1° -15'	21.8	10.35/263	13.15/334	2.2/56

Reducing coupling permit direct reduction on the piping run. Special coatings and hot dip galvanizing are options.

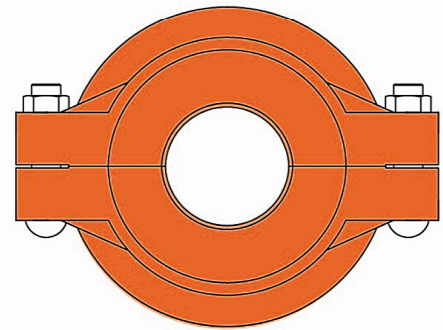

STYLE 25



MATERIAL SPECIFICATIONS

HOUSING:

Ductile Iron conforming to ASTM A-536, Grade 65-45-12

ANSI BOLTS & HEAVY HEX NUTS:

Heat treated, oval-neck track head bolts conforming to ASTM A-183 Grade 2 with a minimum tensile strength of 110,000 psi and heavy hex nuts of carbon steel conforming to ASTM A-563 Grade A or Grade B, or SAEJ995 Grade 2. Bolts and nuts are provided zinc electroplated as standard.

METRIC BOLTS & HEAVY HEX NUTS:

Heat treated, zinc electroplated oval-neck track head bolts made of carbon steel with mechanical properties per ISO 898-1 Class 8.8. Hex nuts and bolts are zinc electroplated followed by a yellow chromate dip.

COATINGS:

- Rust inhibiting paint color: ORANGE(standard)
- Hot Dipped Zinc Galvanized(optional)
- Other available options: Example: RAL3000 Series For other coating requirements contact CPS representative.

Gasket:

- Pre Lube gasket
- Dri-seal gasket
- Standard EPDM

- EPDM: Temperature Range:-34°C~+110°C。
Color Mark: Green。 Suitable for hot water service within specified temperature range plus a variety of dilute acids ,oil free air and many chemical services. UL calssified for cold and hot(82°C)potable water service. Not recommended for hydrocarbon services.
- MVQ: Temperature Range:-70°C~+260°C。
Color Mark:Red。 For drinking water;hot water,oil free air, steam and petroleum.
- NBR: Temperature Range:-28.8°C~+82.2°C。
Color Mark:Orange。
Recommended for hydrocarbon products , air with oil vapors, vegetable oils and mineral oils within specified temperature range。 Not recommended for hot water services over 66°C or for dry air over 60°C。