

- FIREBAG® is a DIN 3586 DVGW certified passive safety device manufactured by TECO since 1995.
- It blocks the gas flow automatically when the ambient temperature reaches 212 °F (in the event of fire).
- When in the tripped position under thermal stress (high-

- temperature resistance 1700 °F for 60 minutes), maintains a gas-tight closure, stopping gas flow, and preventing gas from fueling the fire.
- Available as a single fitting or as device built into valve or appliance.
- Does not require maintenance.

Material	
Body	Cartridge
Zinc plated Steel	Thermo sensitive alloy

TECHNICAL SPECIFICATIONS

Reference standards	Maximum Allowable Operating Pressure (MAOP)	Working temperature	Set-off Temperature	High temperature resistance (Fire Resistance) ⁽¹⁾	Application
DIN 3586 Gas directive EU/2016/426	100 psig	-40 °F - 176 °F ⁽²⁾ [-40 °C - 80 °C]	203 °F - 212 °F [95 °C - 100 °C]	Pressure: 100 psig Temperature: 1700 °F for 60' Leakage ⁽³⁾ : 1.06 ft ³ /h	Natural gas, butane, propane (according EN437:2009 first, second and third family)

NOTE

- A standard coat of primer and paint is permitted on the body of the device. Avoid excessive paint thickness, avoid painting the heat sensor (for devices 1 1/4" - 1 1/2" - 2"), avoid using insulation of any kind which could impair the functioning of the device.

(1) According to DIN3586, the High Temperature Resistance performance is calculated under the following limit conditions: up to a pressure of 72.5 psig (5.0 bar) and a temperature of 1200 °F (650 °C) for 30 minutes.

(2) The device temperature shall never exceed the declared value. Be aware that radiant heat combined with high temperature may lead the device to be exposed to excessive heat.

(3) Measured using the same testing method as described in DIN3586:2003 paragraph 5.10.2

FUNCTION AND INTEGRATED TECHNOLOGIES

FIREBAG® is composed of an external steel body and an internal thermal sensitive device.

When the external temperature reaches 203 °F - 212 °F, the metal alloy that holds the plug to the cartridge melts, and the compression force of the spring pushes the plug against the gas flow orifice, closing it.

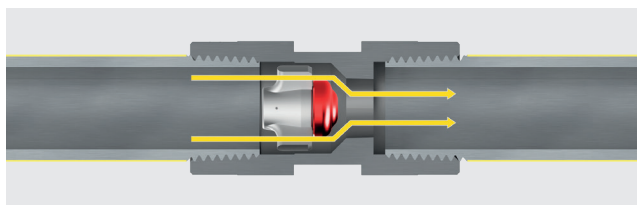

Inactive T < 194 °F

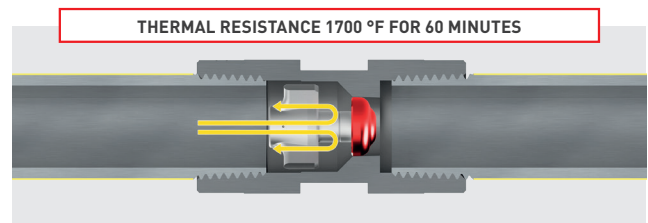

Thermally activated T > 212 °F

FIREBAG® can withstand a temperature of 1700 °F for 60 minutes. Laboratory tests simulating a fire show the room temperature exceeds 1200 °F in 15 minutes (see Temperature chart on right), which also conforms to the temperature endurance required by the DIN 3586 standard.

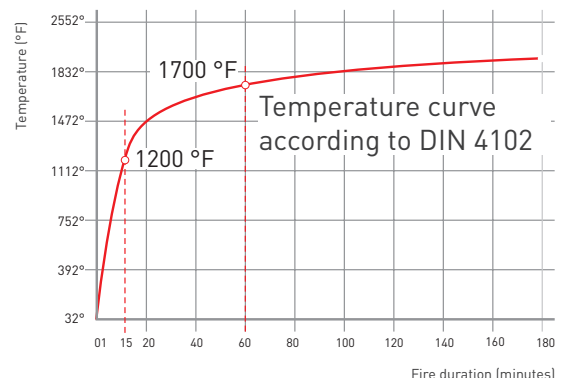

TECO® Americas, LLC
263 Cox Street
Roselle, NJ 07203

+1 908-488-0909
inquiry@tecoamericas.com | tecoamericas.com



TECO® AMERICAS
I N N O V A T I N G G A S S A F E T Y

VERSIONS AND CODES

● FIREBAG fitting threaded NPT – (inlet FEMALE connection / outlet MALE connection)

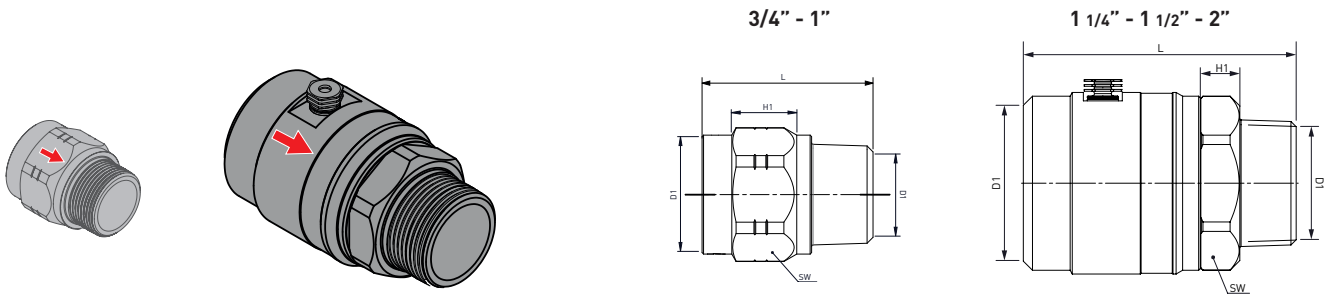

Part Number	Size D1	L ±0.08 (in)	H1 (in)	SW (in)	FLOW RATE ±5% (CFH)	EQUIVALENT LENGTH (ft)	KV	CV
FBAS20001	3/4" - 14 NPT	1.93	0.80	1 1/4"	201.6	14.0	5.7	6.7
FBAS25001	1" - 11.5 NPT	2.26	0.86	1 2/3"	314.3	20.4	8.9	10.4
FBAS32003 ^[4]	1 1/4" - 11.5 NPT	3.62	0.59	2"	777	14.4	22	25.7
FBAS40003 ^[4]	1 1/2" - 11.5 NPT	3.67	0.59	2 1/3"	1130	15.2	32	42.7
FBAS50003 ^[4]	2" - 11.5 NPT	4.72	0.71	2 3/4"	1907	19.6	54	66.7

[4] Upon receipt of a Purchase Order, dimensions will be verified. Verified dimensions may be +/- 2% of listed values.

● FIREBAG fitting threaded NPT – (inlet FEMALE connection / outlet FEMALE connection)

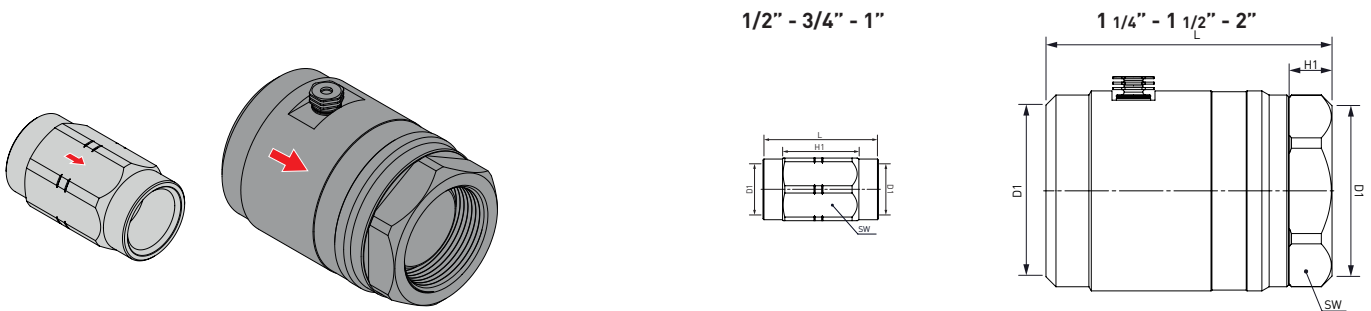

Part Number	Size D1	L ±0.08 (in)	H1 (in)	SW (in)	FLOW RATE ±5% (CFH)	EQUIVALENT LENGTH (ft)	KV	CV
FBAS15004	1/2" - 14 NPT	2.21	1.52	1"	112.7	10.6	3.2	3.7
FBAS20003	3/4" - 14 NPT	2.32	1.53	1 1/4"	201.6	14.0	5.7	6.7
FBAS25003	1" - 11.5 NPT	2.60	1.41	1 2/3"	314.3	20.4	8.9	10.4
FBAS32004 ^[4]	1 1/4" - 11.5 NPT	3.74	0.55	2"	777	14.4	22	25.7
FBAS40004 ^[4]	1 1/2" - 11.5 NPT	3.94	0.59	2 1/3"	1130	15.2	32	42.7
FBAS50004 ^[4]	2" - 11.5 NPT	4.37	0.71	2 3/4"	1907	19.6	54	66.7

[4] Upon receipt of a Purchase Order, dimensions will be verified. Verified dimensions may be +/- 2% of listed values.

VERSIONS AND CODES

● FIREBAG fitting threaded NPT – (inlet MALE connection / outlet FEMALE connection)

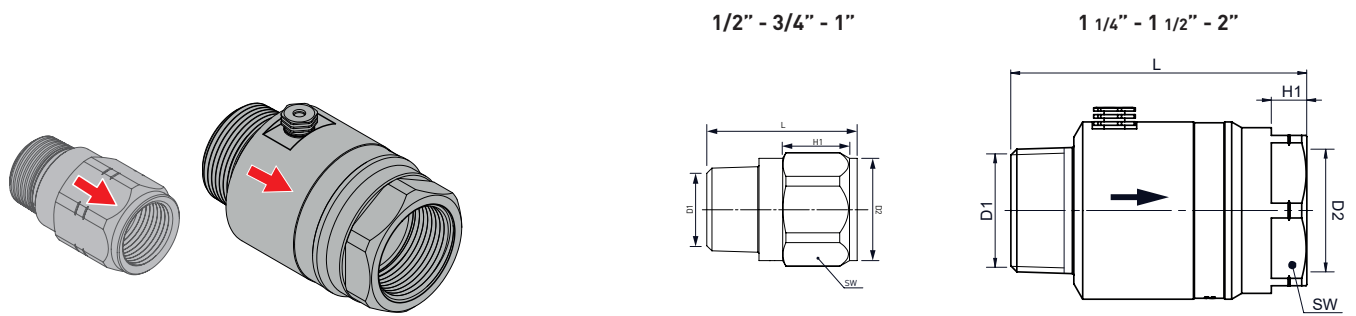

Part Number	Size D1	Size D2	L ±0.08 (in)	H1 (in)	SW (in)	FLOW RATE ±5% (CFH)	EQUIVALENT LENGTH (ft)	KV	CV
FBAS15003 ⁽⁵⁾	1/2" - 14 NPT	3/4" - 14 NPT	2.87	1.14	1 1/4"	267.7	8.3	7.6	8.9
FBAS20002	3/4" - 14 NPT	3/4" - 14 NPT	2.30	1.12	1 1/4"	201.6	13.4	5.8	6.8
FBAS25002	1" - 11.5 NPT	1" - 11.5 NPT	2.34	1.04	1 2/3"	317.5	20.0	9.0	10.5
FBAS32001 ⁽⁴⁾	1 1/4" - 11.5 NPT	1 1/4" - 11.5 NPT	3.94	0.55	2"	777	14.4	22	25.7
FBAS40001 ⁽⁴⁾	1 1/2" - 11.5 NPT	1 1/2" - 11.5 NPT	4.13	0.59	2 1/3"	1130	15.2	32	42.7
FBAS50001 ⁽⁴⁾	2" - 11.5 NPT	2" - 11.5 NPT	4.37	0.71	2 3/4"	1907	19.6	54	66.7

⁽⁴⁾ Upon receipt of a Purchase Order, dimensions will be verified. Verified dimensions may be +/- 2% of listed values.

⁽⁵⁾ Equivalent length estimated with a 3/4" outlet pipe.

● FIREBAG fitting threaded NPT – (inlet MALE connection / outlet MALE connection)

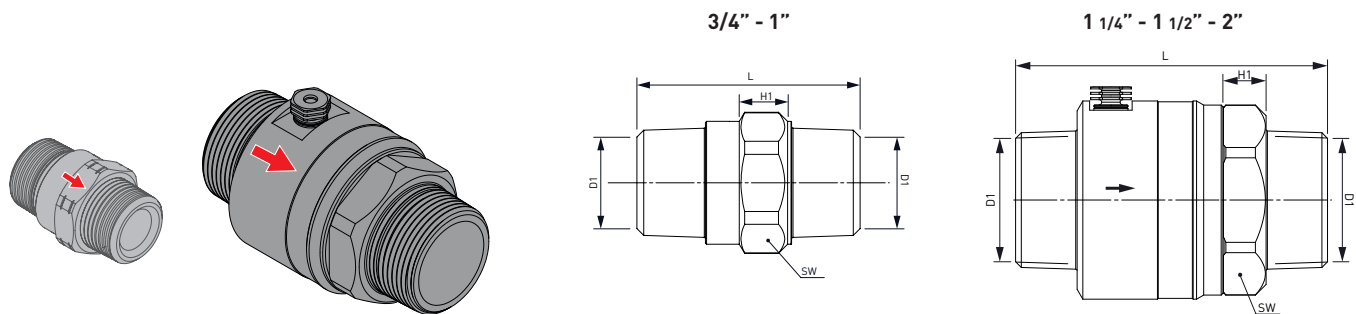

Part Number	Size D1	L ±0.08 (in)	H1 (in)	SW (in)	FLOW RATE ±5% (CFH)	EQUIVALENT LENGTH (ft)	KV	CV
FBAS20004	3/4" - 14 NPT	2.09	0.39	1 1/4"	197.8	14.5	5.6	6.6
FBAS25004	1" - 11.5 NPT	2.41	0.39	1 2/3"	309.0	21.0	8.8	10.2
FBAS32002 ⁽⁴⁾	1 1/4" - 11.5 NPT	4.13	0.55	2"	777	14.4	22	25.7
FBAS40002 ⁽⁴⁾	1 1/2" - 11.5 NPT	4.33	0.59	2 1/3"	1130	15.2	32	42.7
FBAS50002 ⁽⁴⁾	2" - 11.5 NPT	4.72	0.71	2 3/4"	1907	19.6	54	66.7

⁽⁴⁾ Upon receipt of a Purchase Order, dimensions will be verified. Verified dimensions may be +/- 2% of listed values.

VERSIONS AND CODES

FIREBAG fitting threaded NPT – (inlet MALE connection / outlet FEMALE connection)

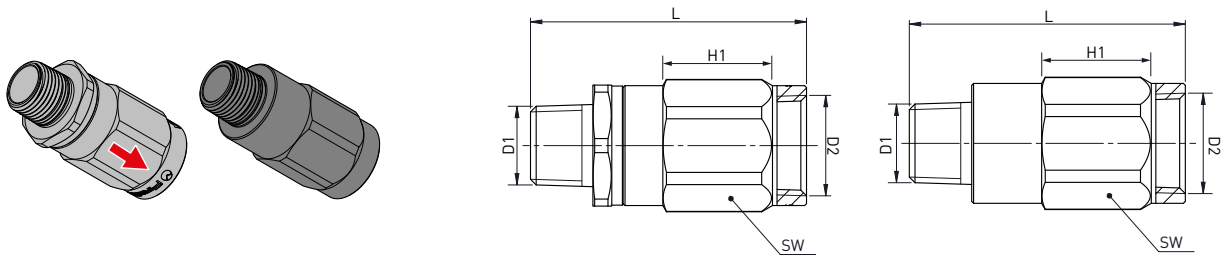

Part Number	Size D1	Size D2	L ±0.08 (in)	H1 (in)	SW (in)	FLOW RATE ±5% (CFH)	EQUIVALENT LENGTH (ft)	KV	CV
OEAS0001	1/2" - 14 NPT	3/4" - 14 NPT	2.87	1.14	1 1/4"	267.7	8.3 ⁽⁵⁾	7.6	8.9

Data is based on the FIREBAG® fitting (FBAS15003) included in the kit.
 (5) Equivalent length estimated with a 3/4" outlet pipe.

FIREBAG fitting threaded NPT – (inlet MALE connection / outlet FEMALE connection)

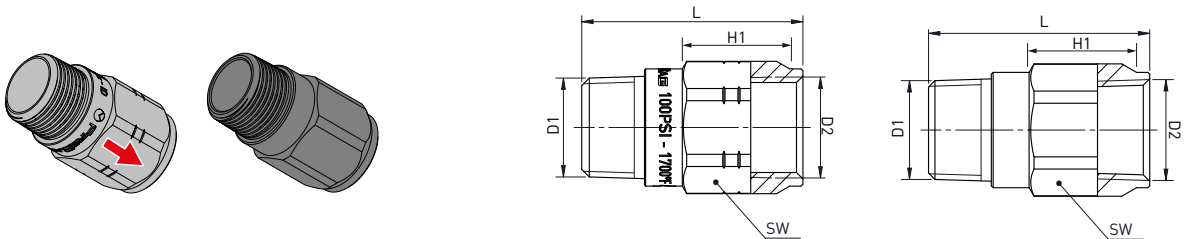

Part Number	Size D1/D2	L ±0.08 (in)	H1 (in)	SW (in)	FLOW RATE ±5% (CFH)	EQUIVALENT LENGTH (ft)	KV	CV
OEAS0002	3/4" 14 NPT	2.30	1.12	1 1/4"	201.6	13.4	5.8	6.8

Data is based on the FIREBAG® fitting (FBAS20002) included in the kit.

FIREBAG fitting threaded NPT – (inlet MALE connection / outlet FEMALE connection)

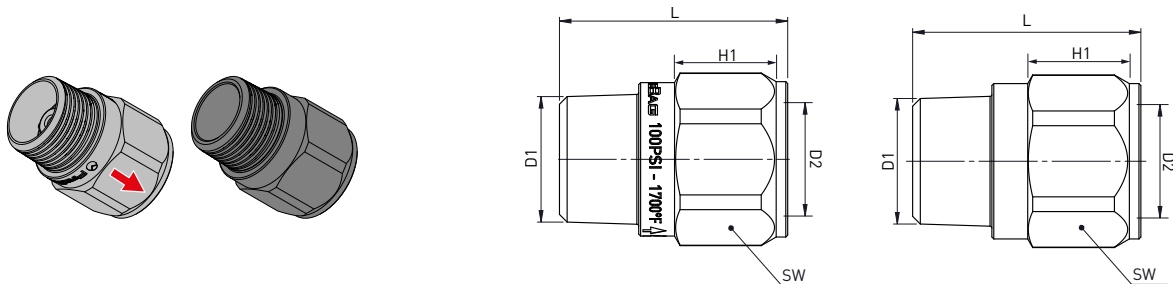

Part Number	Size D1/D2	L ±0.08 (in)	H1 (in)	SW (in)	FLOW RATE ±5% (CFH)	EQUIVALENT LENGTH (ft)	KV	CV
OEAS0006	1" 11.5 NPT	2.34	1.04	1 2/3"	317.5	20.0	9.0	10.5

Data is based on the FIREBAG® fitting (FBAS25002) included in the kit.

PRESSURE DROP GRAPH

Data reference GNUT18004003 / PJUT18021902

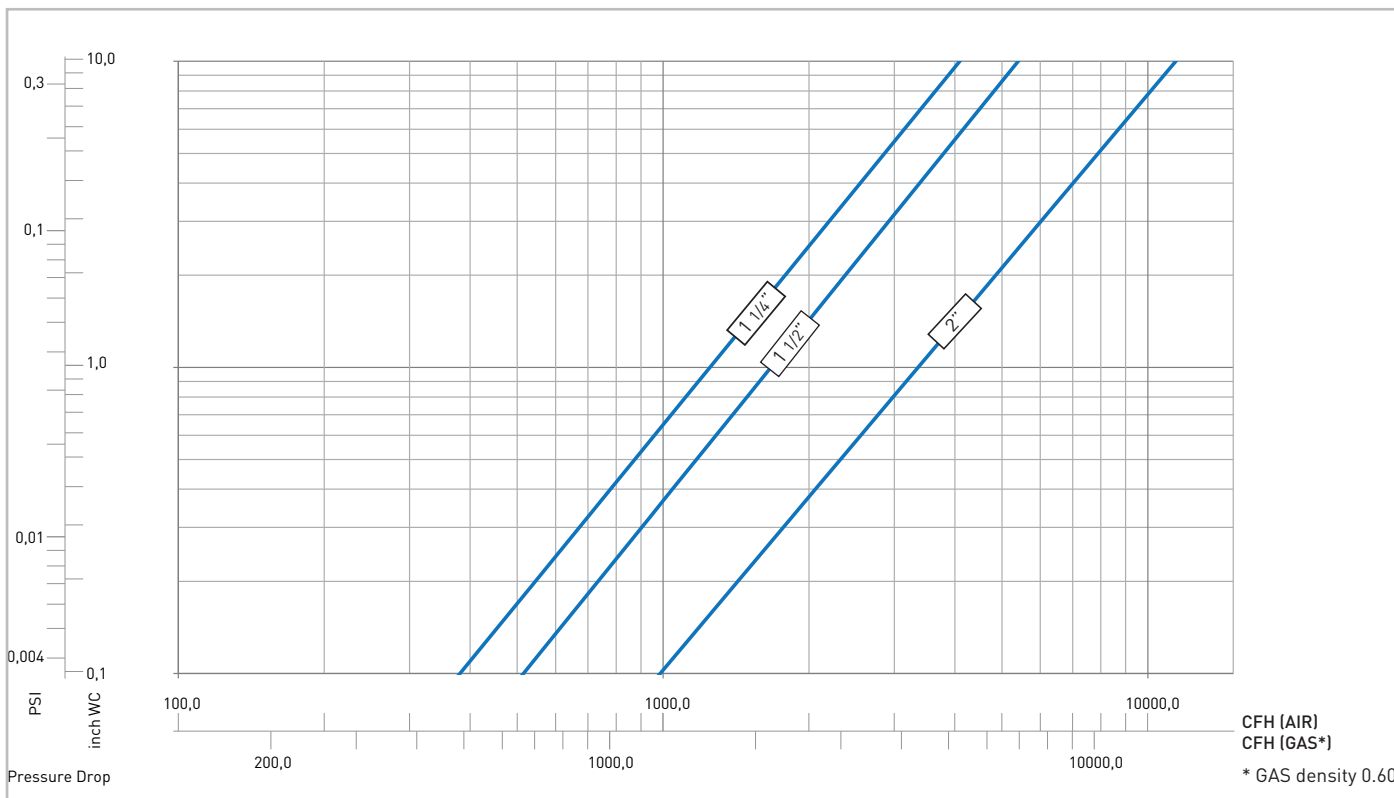
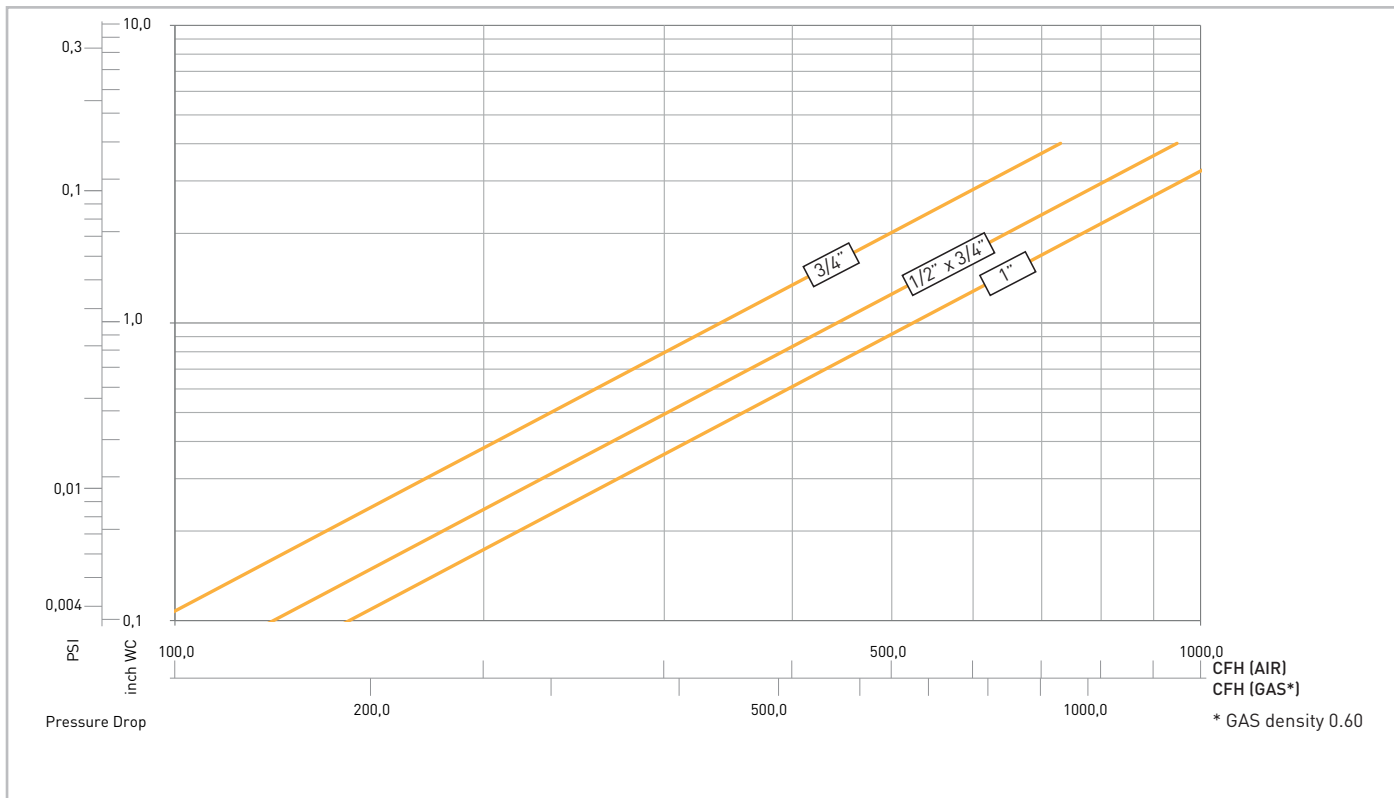

Flow rate/pressure drop diagrams obtained with 10.04 in H₂O (0.36 psig) inlet pressure.

TECO® Americas, LLC
263 Cox Street
Roselle, NJ 07203

+1 908-488-0909
inquiry@tecoamericas.com | tecoamericas.com



TECO® AMERICAS

INNOVATING GAS SAFETY